

MCIVOR FOREST DRIVE, JUNORTOUN

GB5259

ROAD RENEWAL

MAY 2024

DOCUMENT CONTROL				
SHEET No.	SHEETD ESC.	02/05/2024	xx/xx/xx	xx/xx/xx
		DRAFT REVISION	TENDER REVISION	CONSTRUCTION REVISION
1	COVER SHEET	-		
2	GENERAL NOTES	-		
3	OVERALL LAYOUT	-		
4	OVERALL LAYOUT	-		
5	WEST KERB DETAILS	-		
6	EAST KERB DETAILS	-		
7	KERB CROSS SECTIONS	-		
8	DRAINAGE DETAILS	-		

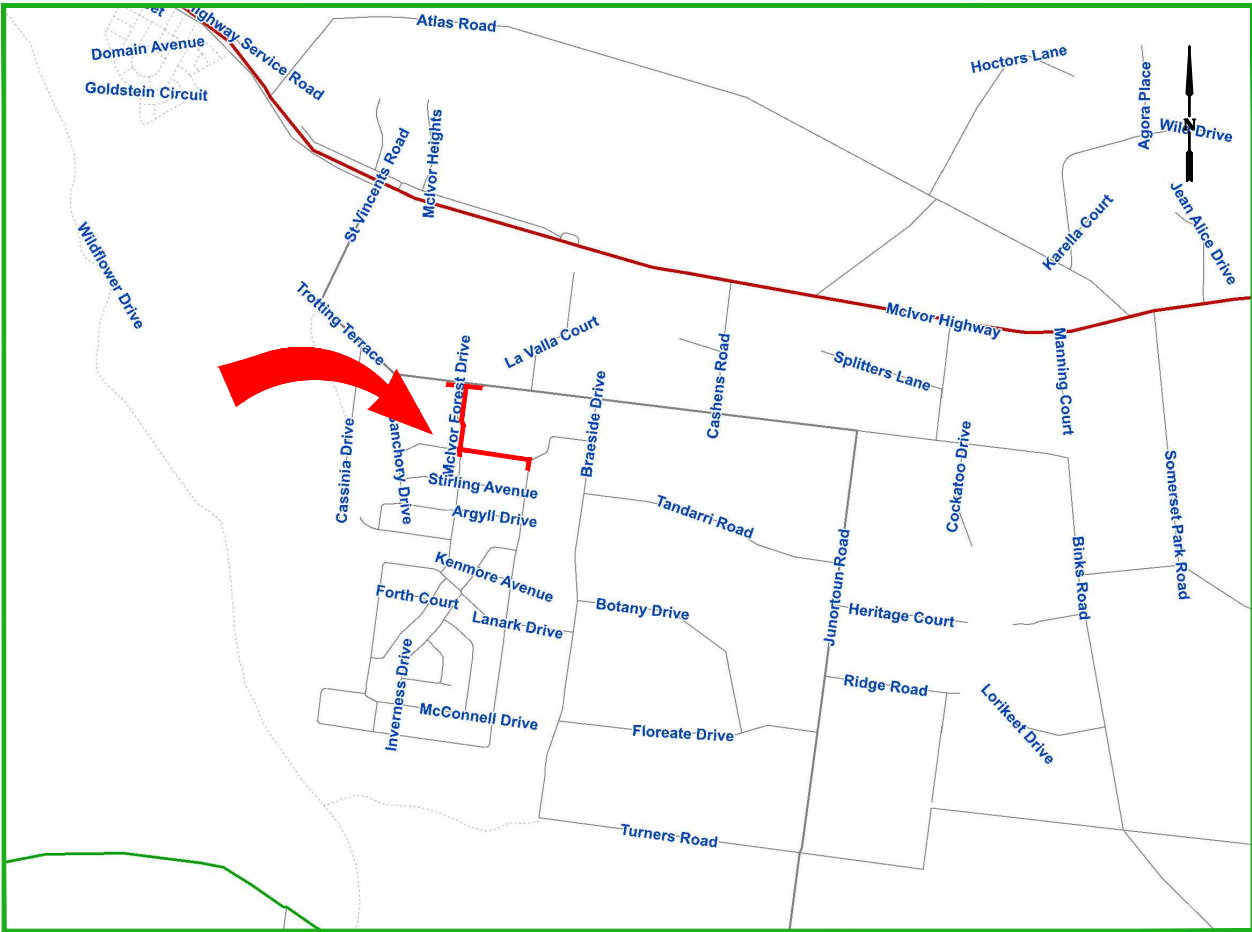

LOCALITY MAP

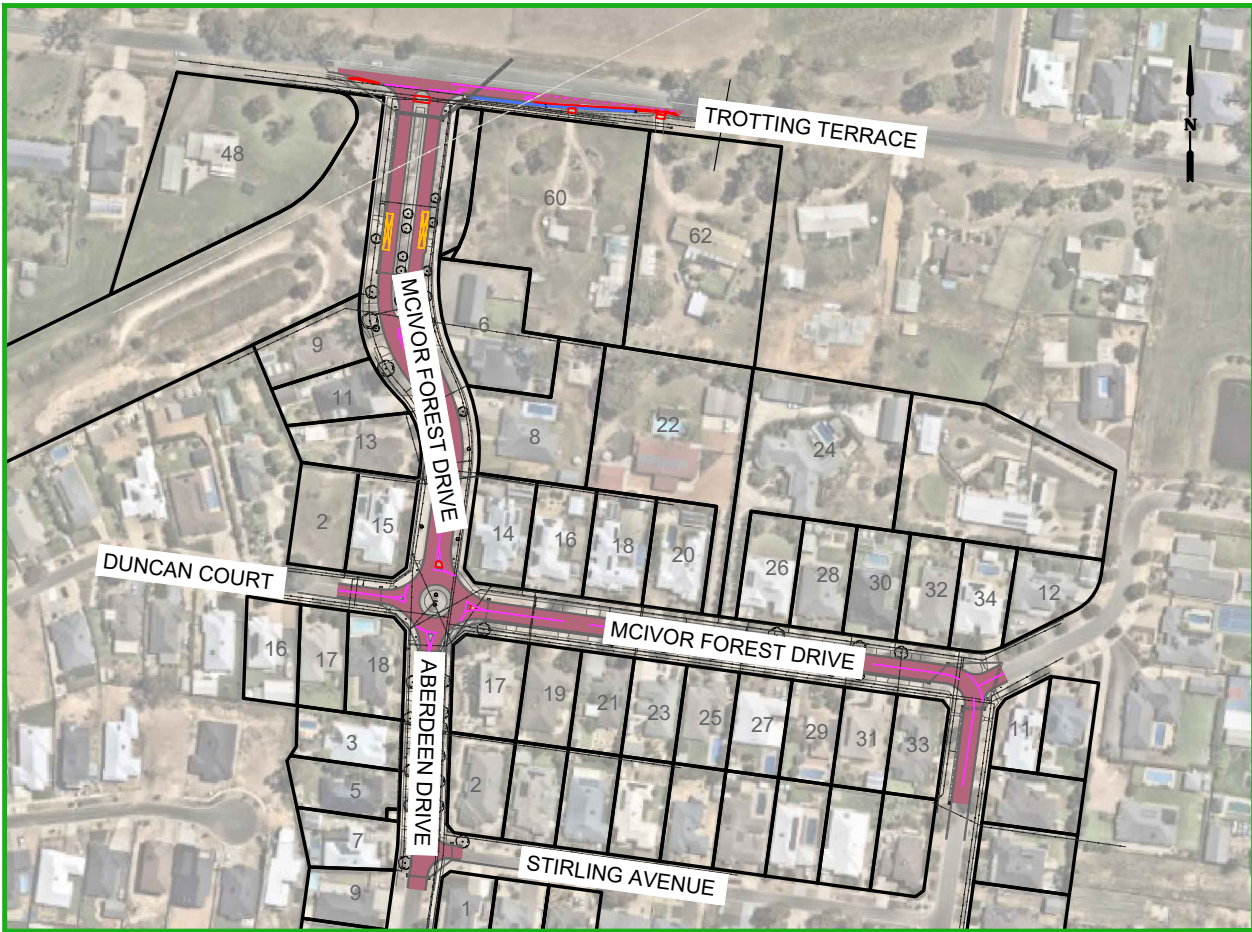

PROJECT EXTENTS

APPROVAL TO CONSTRUCT STAMP		PROJECT PLANNING REQUIREMENTS				<div> CITY OF GREATER BENDIGO</div>	PROJECT DESIGN STATUS			PROJECT DETAILS		SHEET DETAILS			
DO NOT CONSTRUCT WITHOUT STAMP	Item	Required	Comments	Contractor	Surveyor:		H. WHYTOCK	18/07/23	Location: Mclvor Forest Drive	Suburb: Junortoun	Works: Road Renewal	GB No: GB5259	COVER SHEET	Sheet number: 1 of 8	
	Vegetation	No	-		Designer:		B. JANSSEN	Apr 2024						Plan Scale: - A3	
	RRV	No	-		Draft Checked:		M. JENNINGS	xx/xx/24						Plotted: 02/05/2024 By: Bayley Janssen	
	CMA	No	-		Tender Approved:		A. SMITH	xx/xx/24							
	Planning Permit	No	-		<div>PRELIMINARY DESIGN DRAFT 2</div>			SHEET REVISIONS AFTER TENDER							
	Land Acquisition	No	-					Revision	Description	Approved by	Date				
	CHMP	No	-					-	-	-	-				
	Other	No	-					-	-	-	-				

CONSTRUCTION SPECIFICATIONS

All construction undertaken by, or on behalf of, The City of Greater Bendigo (CoGB) shall be undertaken in accordance with all DTP/Vicroads 200-700 series of Standard Specifications.

Compliance with the specifications to the satisfaction of the project Superintendent is required before a project can meet Practical Completion.

Sections of the DTP/Vicroads 200-700 series of standard specifications which are of particular relevance for this project include:

FORMATION

201 Site Clearing
204 Earthworks
205 Rock Fill

FLEXIBLE PAVEMENTS

304 Unbound Flexible Pavement Construction
306 Cementitious Treated Pavement Subbase
307 In Situ Stabilisation of Pavements with Cementitious Binders
308 In Situ Stabilisation of Pavements with Foamed Bitumen Binder
310 Preparation of Granular Pavements for Bituminous Surfacing

ASPHALT AND SURFACE TREATMENTS

402 Removal of Pavement by Cold Planing (profiling)
407 Dense Graded Asphalt

INCIDENTAL CONSTRUCTION

701 Underground Stormwater Drains
703 General Concrete Paving
704 Precast Concrete Kerb
705 Drainage Pits and Covers
710 Fixing Raised Pavement Markers
721 Pavement Markings

MATERIAL SPECIFICATIONS

FOR WORKS DEPARTMENT

All materials used in construction projects undertaken by the CoGB Works department shall be compliant with the specifications setout in the relevant CoGB material panel supply contract.

Where panel supply contract information is not available, material specifications shall be sought from and supplied by the CoGB Engineering Department, and all materials used in construction must comply with those specifications.

FOR EXTERNAL CONSULTANTS (inc. consultants engaged by the Works Dept.)

All materials used by external contractors engaged to undertake CoGB construction projects, or components thereof, shall be as per the material specification supplied within the instrument of engagement (Quote, Tender or Contract), or as per written instruction from the project Superintendents.

PROJECT PLANNING REQUIREMENTS

Permits and approvals

- Project permits and approvals which were required to be obtained prior to construction are listed in the below table
- Construction activities must be compliant with all conditions within the listed permits and approvals.

PROJECT PLANNING REQUIREMENTS			
Item	Required	Comments	Contractor
Vegetation	No	-	
RRV	No	-	
CMA	No	-	
Planning Permit	No	-	
Land Acquisition	No	-	
CHMP	No	-	
Other	No	-	

GENERAL NOTES

STANDARD DRAWINGS

Standard Drawings that are referenced within the design drawings are noted as 'SD', and are sourced from 3 locations. They are available for download online or from the project superintendent:

- 'CoGB SD' are sourced from the City of Greater Bendigo
<https://www.bendigo.vic.gov.au/Services/Roads-and-Drainage/Roads/Construction-standards>
- 'IDM SD' are sourced from the Infrastructure Design Manual
<https://www.designmanual.com.au/>
- 'Vicroads SD' are sourced from Vicroads
<https://www.vicroads.vic.gov.au/business-and-industry/technical-publications/technical-drawings-for-roadworks/standard-drawings-for-roadworks>

SERVICES SHOWN ON PLANS AND DURING CONSTRUCTION

- The location of underground services shown on design drawings have been derived from available information. Accuracy can not be guaranteed and should therefore be treated as indicative only.
- Gas and water property services are not located or shown on design drawings. It is the contractors responsibility to locate and alter these services as required to achieve the project design.
- Prior to undertaking construction activities, exact service locations must be arranged and marked onsite.
- The contractor will be held responsible for any damage caused to services.
- All service pit lids or valve covers within the works area are to be raised or lowered to match the design surface level to the relevant authority standards, unless noted otherwise on the construction plans, or by approval from the superintendent.
- Any service authority marker post found within the works area is to be relocated adjacent to their current position to a point 150mm offset from the nearest property boundary.
- Any PSM covers affected during works are to be renewed to CoGB SD293 unless noted otherwise, or by approval from the superintendent.

DRAINAGE

- Any private storm water pipes discovered during works are to be plumbed to the nearest CoGB drainage pit, or with approval from the superintendent, to the nearest kerb or pipe

CONSTRUCTION MANAGEMENT GUIDANCE

OCCUPATIONAL HEALTH AND SAFETY

Delivery units shall consider appropriate management of occupational health and safety, and develop management plans compliant with ISO45001, and the City of Greater Bendigo integrated management system prior to any works beginning onsite

SITE ENVIRONMENTAL MANAGEMENT PLAN

A Site Environmental Management Plan (SEMP) is to be developed by delivery units to manage the project site during the project delivery window. Consideration shall be given to appropriate management of the following, with a SEMP plan filled out and displayed onsite at all times:

- Communication and induction for staff, contractors and sub contractors
- Communication with appropriate adjacent residents/businesses
- Noise and Vibration
- Dust and contamination
- Chemicals
- Erosion and sediment
- Waste
- Vehicle and roadside management
- Vegetation, with particular focus on any relevant permit conditions and AS4970
- Heritage, with particular focus on any relevant permit conditions

TRAFFIC MANAGEMENT PLAN

Where appropriate and prior to any works starting on site, delivery units must organise a AS1742.3 compliant traffic management plan, and have it approved by the relevant road authority.

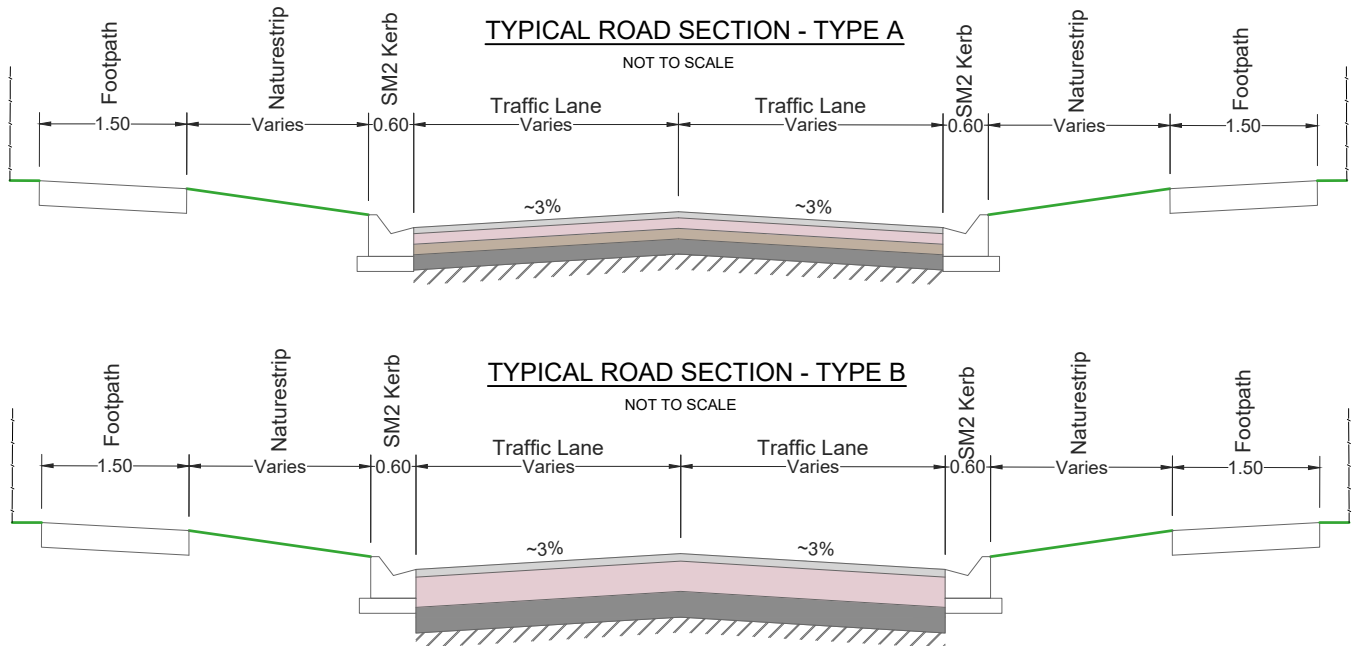

PAVEMENT TYPE A			
KEY	LAYER	DEPTH	THICKNESS
	Asphalt (w)	40mm	Size 14 Type H (C320)
	Asphalt (l)	70mm	Size 20 Type SI (C320)
	Asphalt (B)	70mm	Size 20 Type SI (C320)
	Base	100mm	3% Cement Treated Class 3 FCR (20mm)
	Subgrade		Existing Subgrade or Bedrock (CBR=5%)
	TOTAL	280mm	

PAVEMENT DETAILS - TYPE B			
KEY	LAYER	DEPTH	THICKNESS
	Wearing	40mm	Type HP Asphalt, Size 14mm, A15E Binder.
	Primerseal	10mm	Size 10mm Initial Treatment (C170)
	Base	200mm	Class 1 FCR (20mm) - Compacted in 2 layers
	Sub-Base	170mm	Class 3 FCR (20mm) - Compacted in 2 layers
	Subgrade		Existing subgrade as found (CBR = 5%)
	TOTAL	420mm	

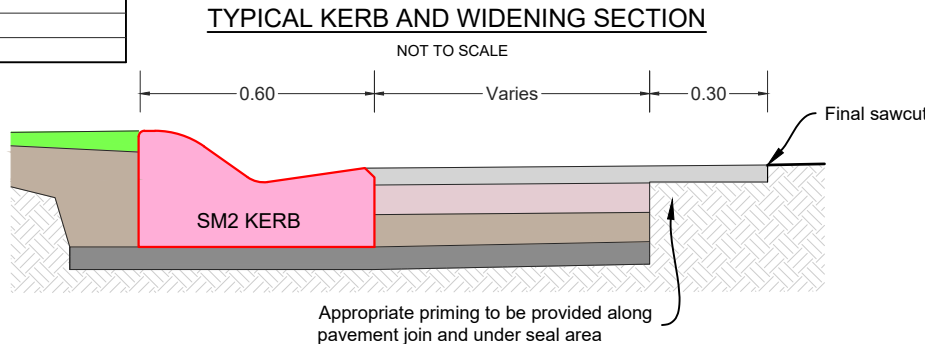

IMPORTANT!
The location of underground services have been derived from available information, however accuracy cannot be guaranteed. All existing service information should therefore be treated as indicative only, and service locations must be arranged prior to commencement of any excavation. The contractor will be held responsible for any damage caused to underground services.

SURVEY NOTES
Survey has been conducted to:
- MGA 2020 and orientated via GPS
- Survey level has been tied to AHD via PM101



PROJECT DESIGN STATUS		
Surveyor:	H. WHYTOCK	18/07/23
Designer:	B. JANSSEN	Apr 2024
Draft Checked:	M. JENNINGS	xx/xx/24
Tender Approved:	A. SMITH	xx/xx/24

**PRELIMINARY DESIGN
DRAFT 2**

PROJECT DETAILS	
Location:	Mclvor Forest Drive
Suburb:	Junortoun
Works:	Road Renewal
GB No:	GB5259

SHEET DETAILS	
GENERAL NOTES	Sheet number: 2 of 8
	Plan Scale: - A3
	Plotted: 02/05/2024 By: Bayley Janssen
SHEET REVISIONS AFTER TENDER	
Revision	Description
-	-
-	-
-	-

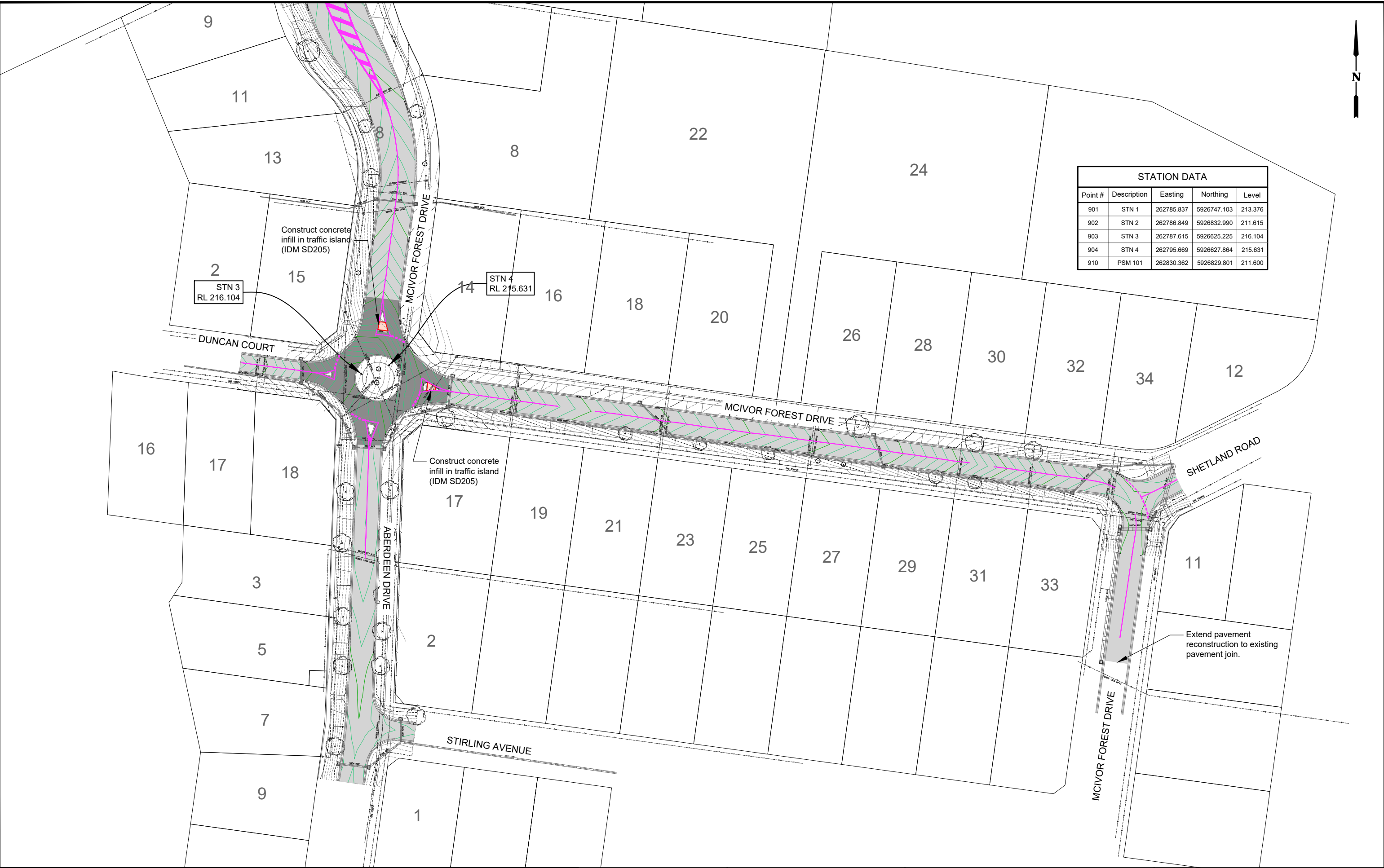

STATION DATA				
Point #	Description	Easting	Northing	Level
901	STN 1	262785.837	5926747.103	213.376
902	STN 2	262786.849	5926832.990	211.615
903	STN 3	262787.615	5926625.225	216.104
904	STN 4	262795.669	5926627.864	215.631
910	PSM 101	262830.362	5926829.801	211.600

LEGEND			
	DESIGN LINEMARKING (WHITE)		DESIGN CONTOURS - Levels to AHD (0.10m interval)
	DESIGN LINEMARKING (YELLOW)		DESIGN PAVEMENT: TYPE A (Refer: Typical road pavement detail.)
	DESIGN SAWCUT		DESIGN PAVEMENT: TYPE B (Refer: Typical road pavement detail.)
	TREE REMOVALS		CONCRETE INFILL: NORMAL PLAIN IDM SD205
	EXISTING CONTOURS - Levels to AHD (0.10m interval)		



PROJECT DESIGN STATUS		
Surveyor:	H. WHYTOCK	18/07/23
Designer:	B. JANSSEN	Apr 2024
Draft Checked:	M. JENNINGS	xx/xx/24
Tender Approved:	A. SMITH	xx/xx/24
PRELIMINARY DESIGN DRAFT 2		

PROJECT DETAILS	
Location:	McIvor Forest Drive
Suburb:	Junortoun
Works:	Road Renewal
GB No:	GB5259

SHEET DETAILS	
OVERALL LAYOUT	
Sheet number:	3 of 8
Plan Scale:	1:1000
Plotted:	02/05/2024 By: Bayley Janssen
SHEET REVISIONS AFTER TENDER	
Revision	Description
-	-
-	-
-	-
-	-

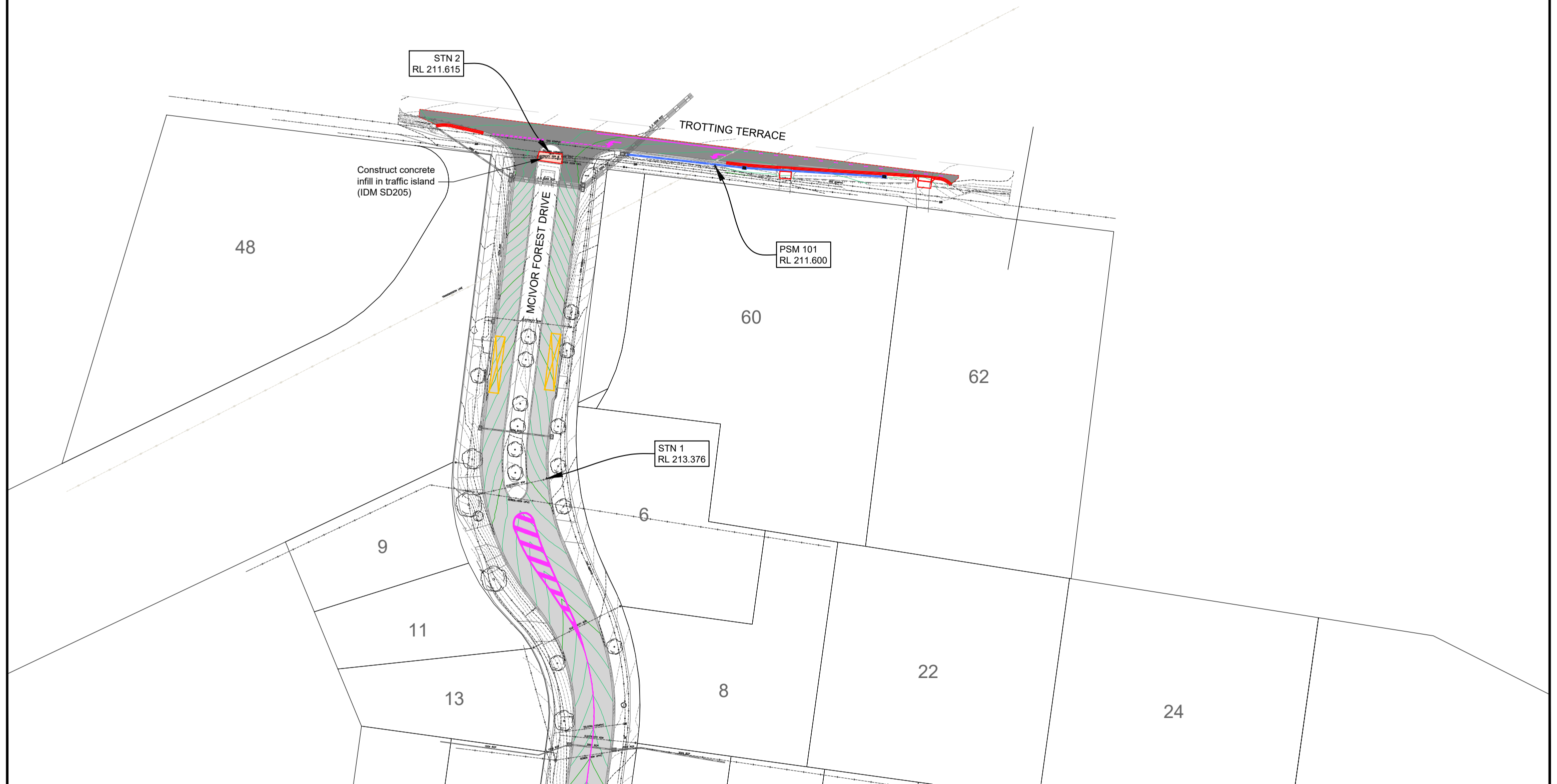

LEGEND

	DESIGN LINEMARKING (WHITE)		DESIGN CONTOURS - Levels to AHD (0.10m interval)		DESIGN PAVEMENT: TYPE A (Refer: Typical road pavement detail.)
	DESIGN LINEMARKING (YELLOW)		EXISTING CONTOURS - Levels to AHD (0.10m interval)		DESIGN PAVEMENT: TYPE B (Refer: Typical road pavement detail.)
	DESIGN SAWCUT				CONCRETE INFILL: NORMAL PLAIN IDM SD205
	TREE REMOVALS				

PROJECT DESIGN STATUS		
Surveyor:	H. WHYTECK	18/07/23
Designer:	B. JANSSEN	Apr 2024
Draft Checked:	M. JENNINGS	xx/xx/24
Tender Approved:	A. SMITH	xx/xx/24

PRELIMINARY DESIGN
DRAFT 2

PROJECT DETAILS	
Location:	McIvor Forest Drive
Suburb:	Junortoun
Works:	Road Renewal
GB No:	GB5259

SHEET DETAILS	
OVERALL LAYOUT	
Sheet number: 4 of 8	
Plan Scale: 1:1000 A3	
Plotted: 02/05/2024 By: Bayley Janssen	
SHEET REVISIONS AFTER TENDER	
Revision	Description
-	-
-	-
-	-

Approved by		Date
-	-	-
-	-	-
-	-	-

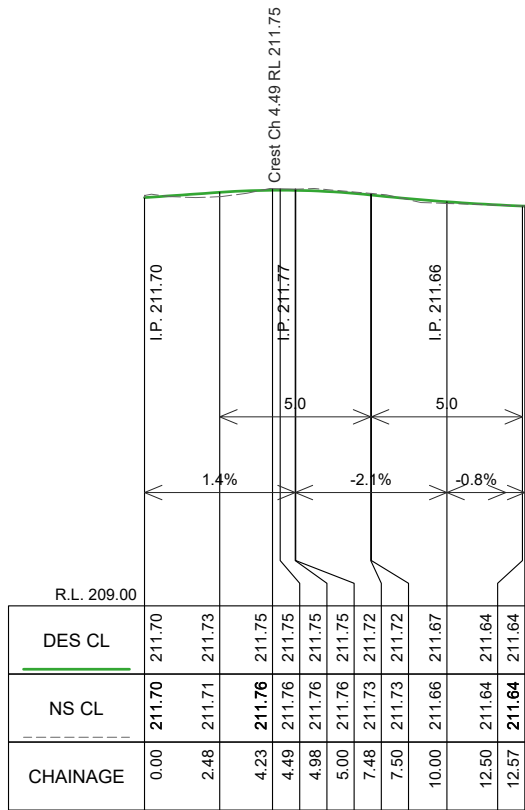
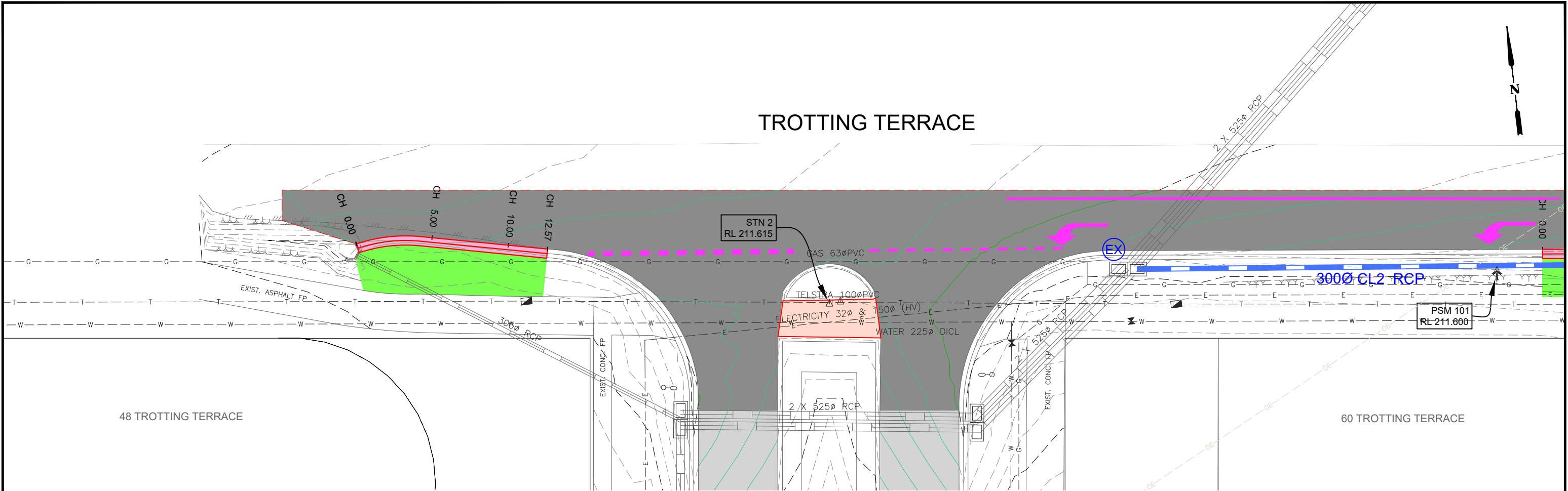

TROTTER TERRACE - WEST KERB LONGITUDINAL SECTION CH 0.000 To 12.575
SCALES: H 1:250 V 1:50 (A3)

LEGEND

DESIGN CONTOURS
- Levels to AHD (0.10m interval)

EXISTING CONTOURS
- Levels to AHD (0.10m interval)

CONCRETE KERB AREA: NORMAL PLAIN
Kerb per IDM SD100 (SM2)

LANDSCAPE AREA: INSTANT TURF
Kykuyu Instant turf on 75mm topsoil

DESIGN PAVEMENT: TYPE A
(Refer. Pavement details pg 2)

DESIGN PAVEMENT: TYPE B
(Refer. Pavement details pg 2)

GRAVEL DRIVEWAY
50mm depth gravel

CONCRETE INFILL: NORMAL PLAIN
IDM SD205

DESIGN LINEMARKING (WHITE)

DESIGN LINEMARKING (YELLOW)

PROJECT DESIGN STATUS

Surveyor:

H. WHYTOCK

18/07/23

Designer:

B. JANSSEN

Apr 2024

Draft Checked:

M. JENNINGS

xx/xx/24

Tender Approved:

A. SMITH

xx/xx/24

PRELIMINARY DESIGN
DRAFT 2

PROJECT DETAILS

Location:

Mclvor Forest Drive

Suburb:

Junortoun

Works:

Road Renewal

GB No:

GB5259

SHEET DETAILS

WEST KERB
DETAILS

Sheet number:

5 of 8

Plan Scale:

1:250

A3

Plotted:

02/05/2024

By: Bayley Janssen

SHEET REVISIONS AFTER TENDER

Revision	Description	Approved by	Date
-	-	-	-
-	-	-	-
-	-	-	-

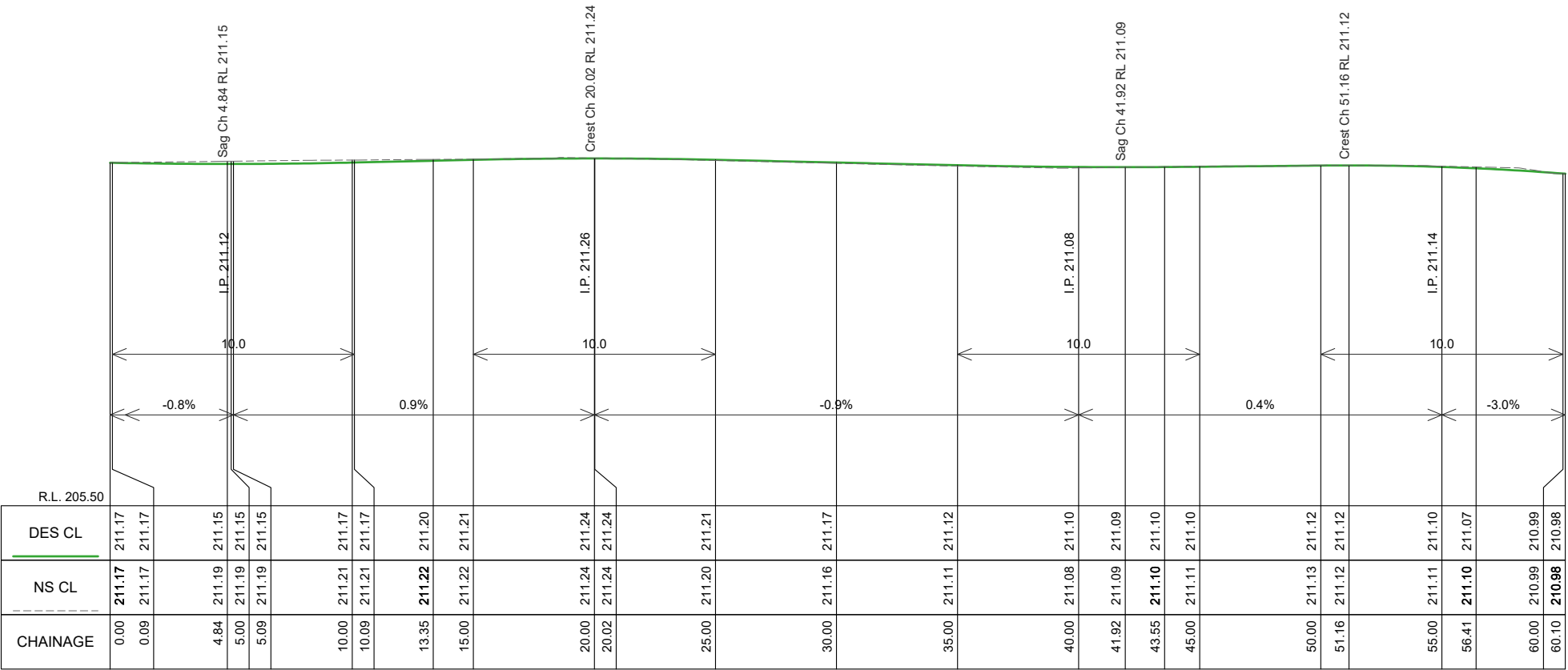
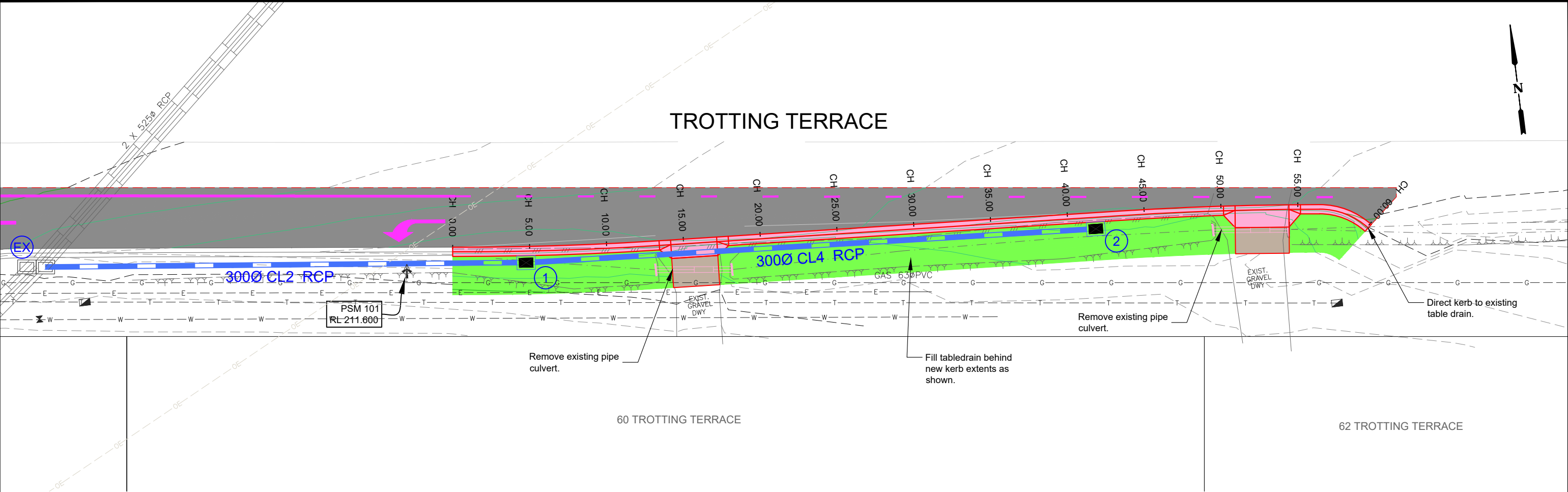

TROTTING TERRACE - EAST KERB LONGITUDINAL SECTION CH 0.000 To 60.097
SCALES: H 1:250 V 1:100 (A3)

LEGEND

DESIGN CONTOURS
- Levels to AHD (0.10m interval)

EXISTING CONTOURS
- Levels to AHD (0.10m interval)

CONCRETE KERB AREA: NORMAL PLAIN
Kerb per IDM SD100 (SM2)

LANDSCAPE AREA: INSTANT TURF
Kykuyu Instant turf on 75mm topsoil

DESIGN PAVEMENT: TYPE A
(Refer. Pavement details pg 2)

DESIGN PAVEMENT: TYPE B
(Refer. Pavement details pg 2)

GRAVEL DRIVEWAY
50mm depth gravel

CONCRETE INFILL: NORMAL PLAIN
IDM SD205

DESIGN LINEMARKING (WHITE)

DESIGN LINEMARKING (YELLOW)

PROJECT DESIGN STATUS

Surveyor: H. WHYTECK18/07/23

Designer: B. JANSSENApr 2024

Draft Checked: M. JENNINGSxx/xx/24

Tender Approved: A. SMITHxx/xx/24

PRELIMINARY DESIGN
DRAFT 2

PROJECT DETAILS

Location: Mclvor Forest Drive

Suburb: Junortoun

Works: Road Renewal

GB No: GB5259

SHEET DETAILS

EAST KERB DETAILS

Sheet number: 6 of 8

Plan Scale: 1:250A3

Plotted: 02/05/2024 By: Bayley Janssen

SHEET REVISIONS AFTER TENDER

Revision	Description	Approved by	Date
-	-	-	-
-	-	-	-
-	-	-	-

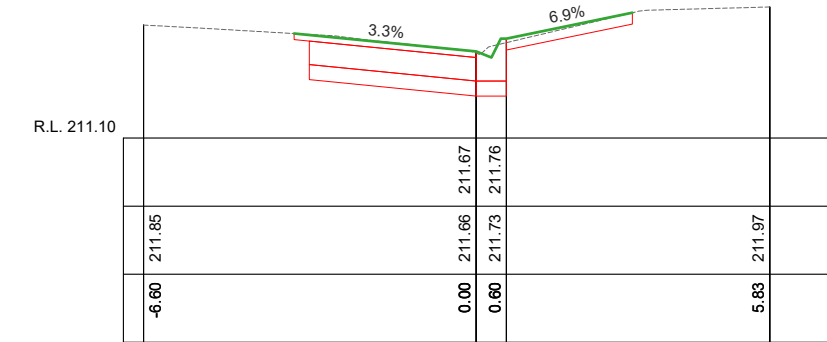

Ch 10.00

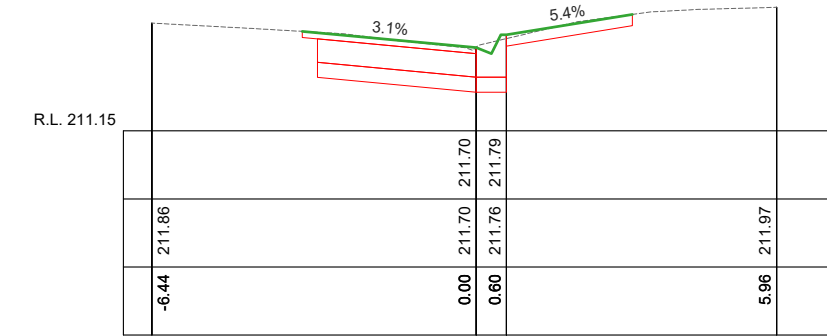

Ch 8.34

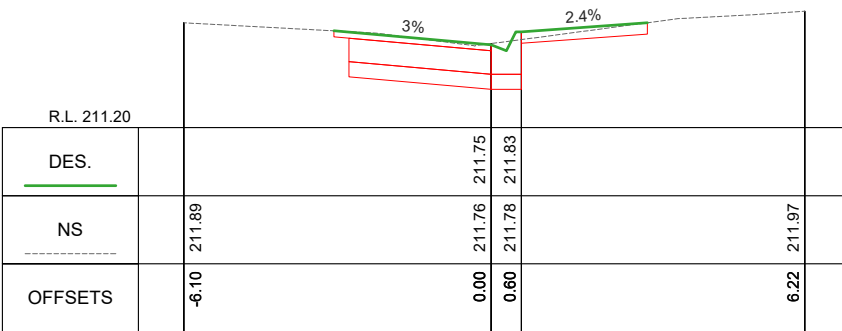

Ch 5.00

WEST KERB CROSS SECTIONS
SCALES: H 1:150 V 1:50 (A3)

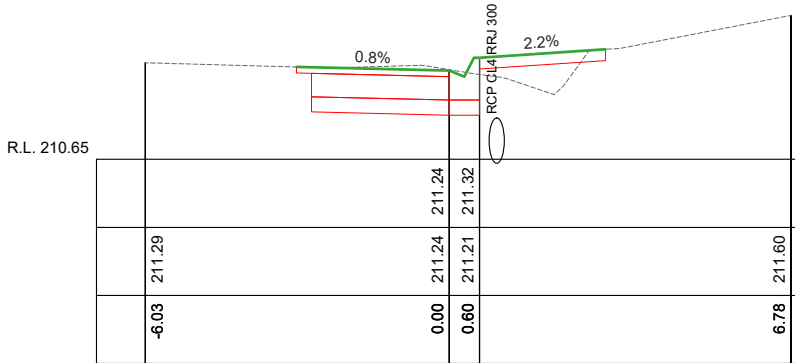

Ch 20.00

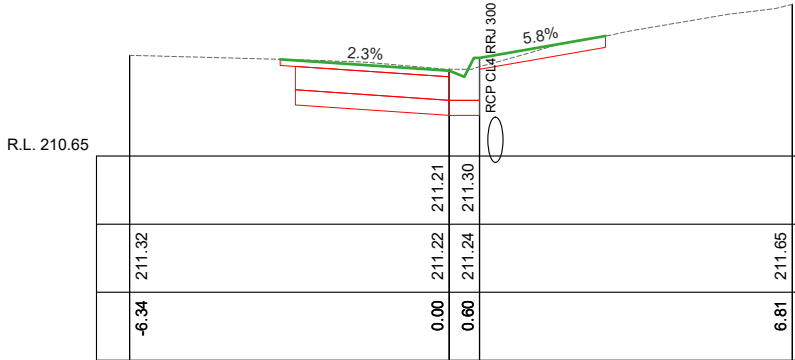

Ch 15.00

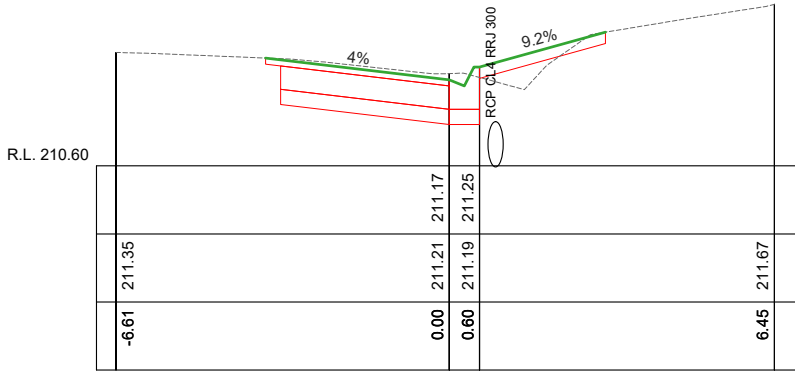

Ch 10.00

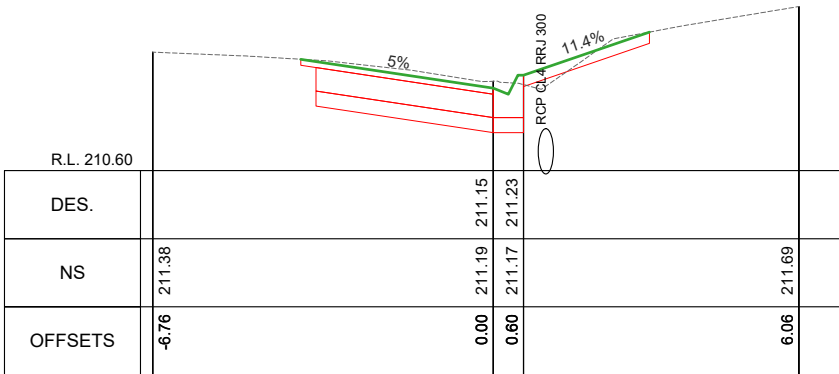

Ch 5.00

EAST KERB CROSS SECTIONS
SCALES: H 1:150 V 1:50 (A3)

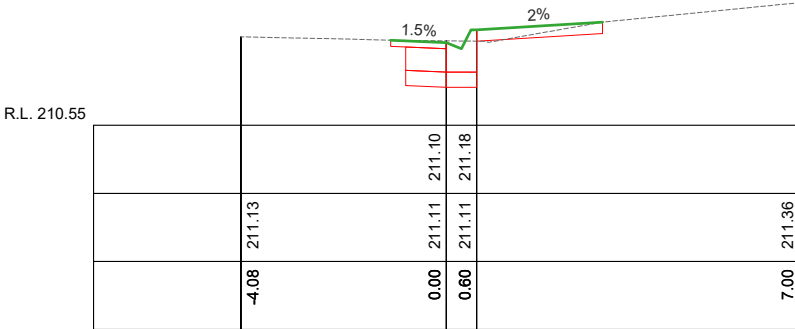

Ch 55.00

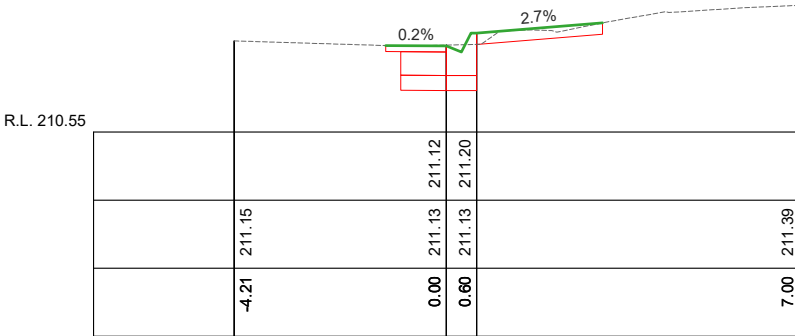

Ch 50.00

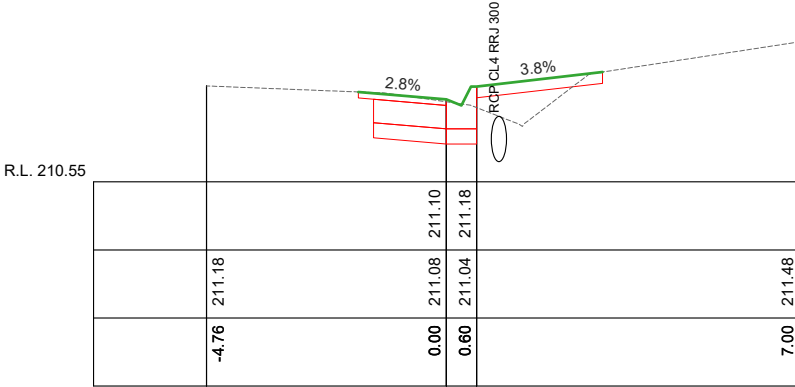

Ch 40.00

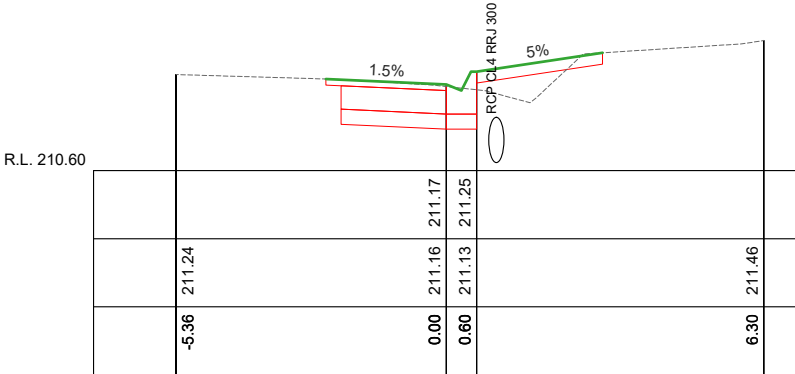

Ch 30.00



PROJECT DESIGN STATUS		
Surveyor:	H. WHYTOCK	18/07/23
Designer:	B. JANSSEN	Apr 2024
Draft Checked:	M. JENNINGS	xx/xx/24
Tender Approved:	A. SMITH	xx/xx/24

PRELIMINARY DESIGN
DRAFT 2

PROJECT DETAILS	
Location:	Mclvor Forest Drive
Suburb:	Junortoun
Works:	Road Renewal
GB No:	GB5259

SHEET DETAILS	
KERB CROSS SECTIONS	
Sheet number:	7 of 8
Plan Scale:	AS SHOWN A3
Plotted: 02/05/2024 By: Bayley Janssen	
SHEET REVISIONS AFTER TENDER	
Revision	Description
-	-
-	-
-	-

Pit Schedule										
Pit No.	Pit Type	Standard Drawing	Pit Width	Pit Length	Outlet Diameter	Outlet Invert RL	Inlet Diameter	Inlet Invert RL	Pit Depth	Pit Lid Level
			(mm)	(mm)	(mm)	(m)	(mm)	(m)	(m)	(m)
1	Side Entry Pit	COGB SD590-A-D-G-T	600	900	300	210.547	300	210.577	0.736	211.283
2	Side Entry Pit	COGB SD590-A-D-G-T	600	900	300	210.688			0.508	211.196

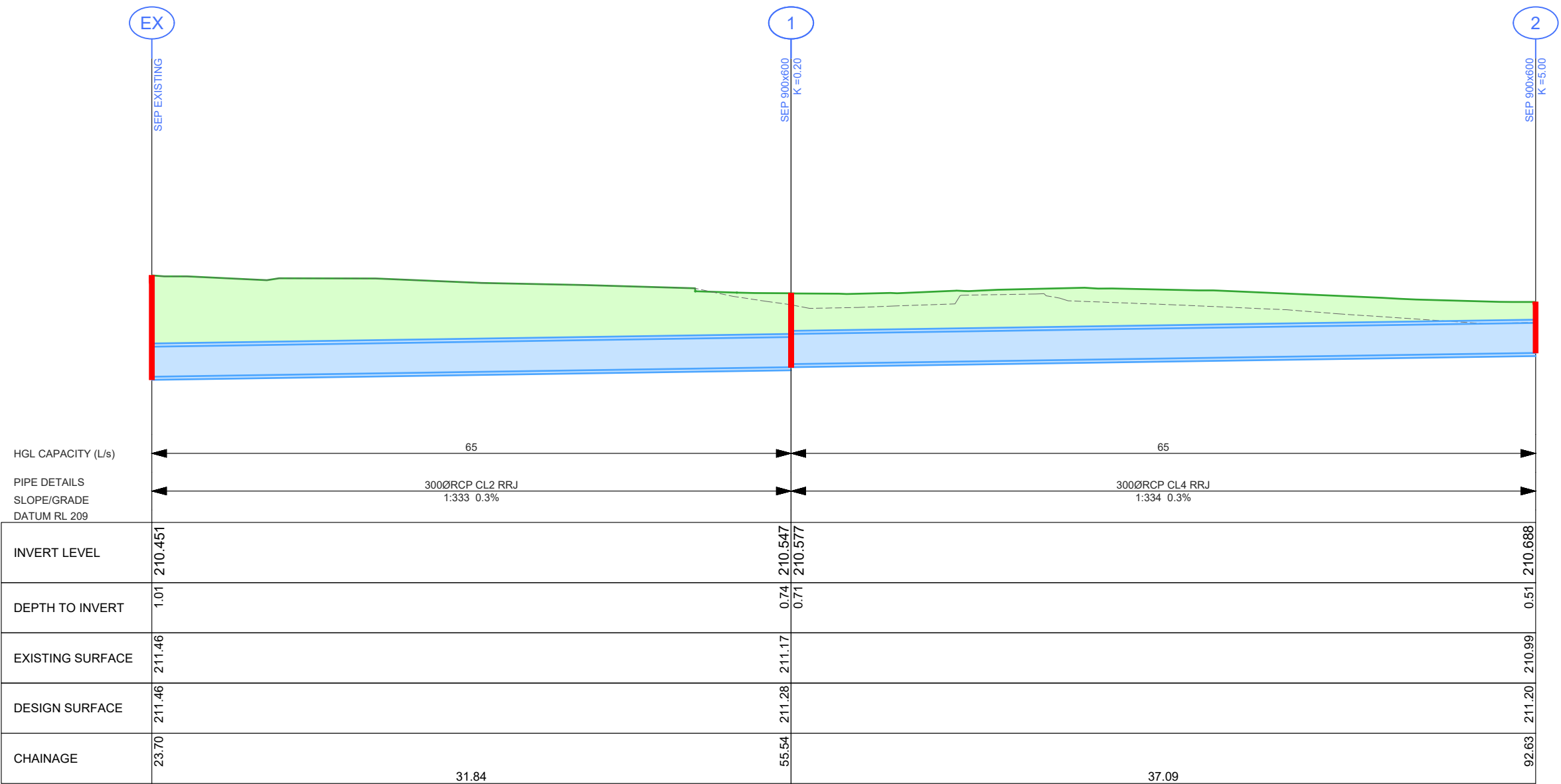

DRAINAGE LONGITUDINAL SECTION
SCALES: HORIZONTAL 1:250 VERTICAL 1:50

PROJECT DESIGN STATUS		
Surveyor:	H. WHYTECK	18/07/23
Designer:	B. JANSSEN	Apr 2024
Draft Checked:	M. JENNINGS	xx/xx/24
Tender Approved:	A. SMITH	xx/xx/24

PRELIMINARY DESIGN
DRAFT 2

PROJECT DETAILS	
Location:	Mclvor Forest Drive
Suburb:	Junortoun
Works:	Road Renewal
GB No:	GB5259

SHEET DETAILS	
DRAINAGE DETAILS	
Sheet number: 8 of 8	
Plan Scale: AS SHOWN A3	
Plotted: 02/05/2024 By: Bayley Janssen	
SHEET REVISIONS AFTER TENDER	
Revision	Description
-	-
-	-
-	-