

CONSTRUCTION SPECIFICATIONS

All construction undertaken by, or on behalf of, The City of Greater Bendigo (CoGB) shall be undertaken in accordance with all DTP/Vicroads 200-700 series of Standard Specifications.

Compliance with the specifications to the satisfaction of the project Superintendent is required before a project can meet Practical Completion.

Sections of the DTP/Vicroads 200-700 series of standard specifications which are of particular relevance for this project include:

FORMATION

- 201 Site Clearing
- 204 Earthworks

FLEXIBLE PAVEMENTS

- 304 Unbound Flexible Pavement Construction
- 310 Preparation of Granular Pavements for Bituminous Surfacing

ASPHALT AND SURFACE TREATMENTS

- 407 Dense Graded Asphalt
- 408 Sprayed Bituminous Surfacing

INCIDENTAL CONSTRUCTION

- 701 Underground Stormwater Drains
- 702 Subsurface Drainage
- 703 General Concrete Paving
- 705 Drainage Pits and Covers
- 714 Sign Installation

MATERIAL SPECIFICATIONS

FOR WORKS DEPARTMENT

All materials used in construction projects undertaken by the CoGB Works department shall be compliant with the specifications setout in the relevant CoGB material panel supply contract.

Where panel supply contract information is not available, material specifications shall be sought from and supplied by the CoGB Engineering Department, and all materials used in construction must comply with those specifications.

FOR EXTERNAL CONSULTANTS (inc.contractors engaged by the Work Dept.)

All materials used by external contractors engaged to undertake CoGB construction projects, or components thereof, shall be as per the material specification supplied within the instrument of engagement (Quote, Tender or Contract), or as per written instruction from the project Superintendents.

PROJECT PLANNING REQUIREMENTS

Permits and approvals

- Project permits and approvals which were required to be obtained prior to construction are listed in the below table
- Construction activities must be compliant with all conditions within the listed permits and approvals.

PROJECT PLANNING REQUIREMENTS			
Item	Required	Approved	Comments
Vegetation	No	No	-
DTP - Vicroads	Yes	No	For comment only
CMA	No	No	-
Planning Permit	No	No	-
Land Acquisition	No	No	-
CHIMP	No	No	-
Other	No	No	-

GENERAL NOTES

STANDARD DRAWINGS

Standard Drawings that are referenced within the design drawings are noted as 'SD', and are sourced from 3 locations. They are available for download online or from the project superintendent:

- 'CoGB SD' are sourced from the City of Greater Bendigo
<https://www.bendigo.vic.gov.au/Services/Roads-and-Drainage/Roads/Construction-standards>
- 'IDM SD' are sourced from the Infrastructure Design Manual
<https://www.designmanual.com.au/>
- 'Vicroads SD' are sourced from Vicroads
<https://www.vicroads.vic.gov.au/business-and-industry/technical-publications/technical-drawings-for-roadworks/standard-drawings-for-roadworks>

SERVICES SHOWN ON PLANS AND DURING CONSTRUCTION

- The location of underground services shown on design drawings have been derived from available information. Accuracy can not be guaranteed and should therefore be treated as indicative only.
- Gas and water property services are not located or shown on design drawings. It is the contractors responsibility to locate and alter these services as required to achieve the project design.
- Prior to undertaking construction activities, exact service locations must be arranged and marked onsite.
- The contractor will be held responsible for any damage caused to services.
- All service pit lids or valve covers within the works area are to be raised or lowered to match the design surface level to the relevant authority standards, unless noted otherwise on the construction plans, or by approval from the superintendent.
- Any service authority marker post found within the works area is to be relocated adjacent to their current position to a point 150mm offset from the nearest property boundary.
- Any PSM covers affected during works are to be renewed to CoGB SD293 unless noted otherwise, or by approval from the superintendent.

DRAINAGE

- Any private storm water pipes discovered during works are to be plumbed to the nearest CoGB drainage pit, or with approval from the superintendent, to the nearest kerb or pipe

CONSTRUCTION MANAGEMENT GUIDANCE

OCCUPATIONAL HEALTH AND SAFETY

Delivery units shall consider appropriate management of occupational health and safety, and develop management plans compliant with ISO45001, and the City of Greater Bendigo integrated management system prior to any works beginning onsite

SITE ENVIRONMENTAL MANAGEMENT PLAN

A Site Environmental Management Plan (SEMP) is to be developed by delivery units to manage the project site during the project delivery window. Consideration shall be given to appropriate management of the following, with a SEMP plan filled out and displayed onsite at all times:

- Communication and induction for staff, contractors and sub contractors
- Communication with appropriate adjacent residents/businesses
- Noise and Vibration
- Dust and contamination
- Chemicals
- Erosion and sediment
- Waste
- Vehicle and roadside management
- Vegetation, with particular focus on any relevant permit conditions and AS4970
- Heritage, with particular focus on any relevant permit conditions

TRAFFIC MANAGEMENT PLAN

Where appropriate and prior to any works starting on site, delivery units must organise a AS1742.3 compliant traffic management plan, and have it approved by the relevant road authority.

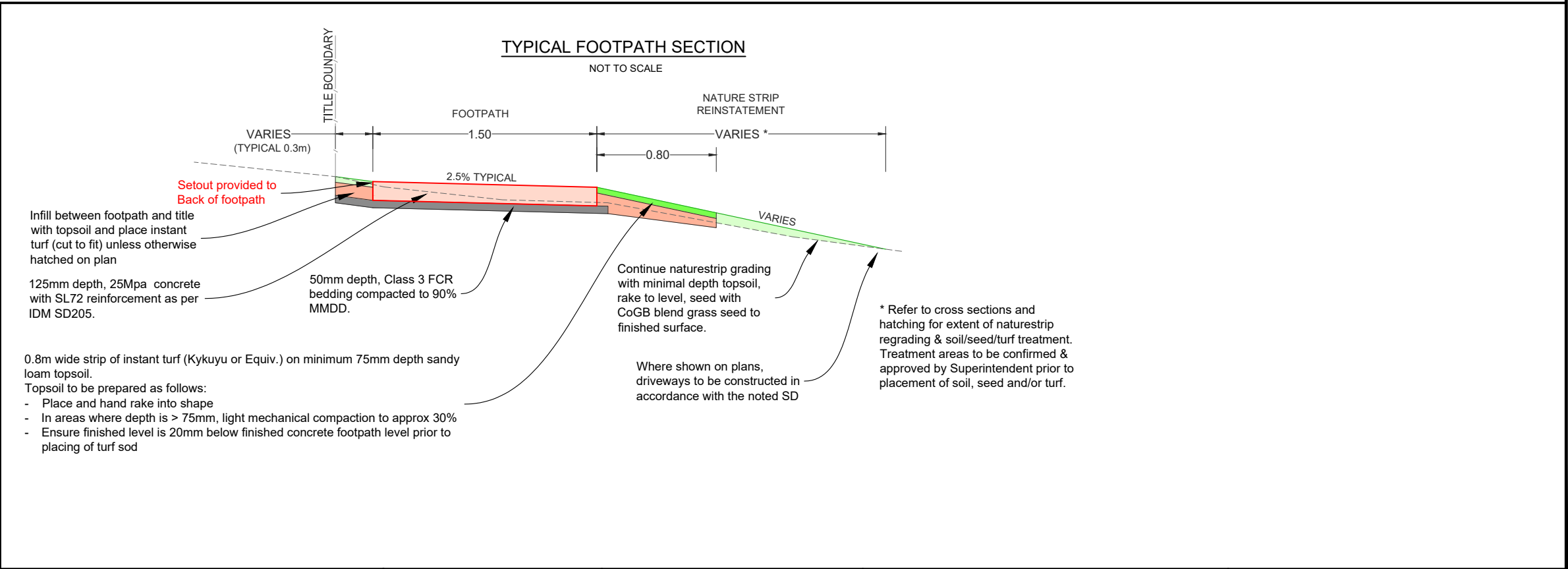



IMPORTANT!
The location of underground services have been derived from available information, however accuracy cannot be guaranteed. All existing service information should therefore be treated as indicative only, and service locations must be arranged prior to commencement of any excavation. The contractor will be held responsible for any damage caused to underground services.



PROJECT DESIGN STATUS		
Surveyor:	H. Whytock	30/03/2023
Designer:	A. Smith	04/04/2023
Draft Checked:	L. Oliver	xx/xx/23
Tender Approved:	N. SARTORI	xx/xx/23

PRELIMINARY DESIGN
DRAFT 3

PROJECT DETAILS	
Location:	Marong Road
Suburb:	West Bendigo
Works:	Footpath
GB No:	GB5098

SHEET DETAILS			
GENERAL NOTES		Sheet number:	2 of 10
		Plan Scale:	- A3
		Plotted:	24/05/2023 By:Andrew Smith
SHEET REVISIONS AFTER TENDER			
Revision	Description	Approved by	Date
-	-	-	-
-	-	-	-
-	-	-	-

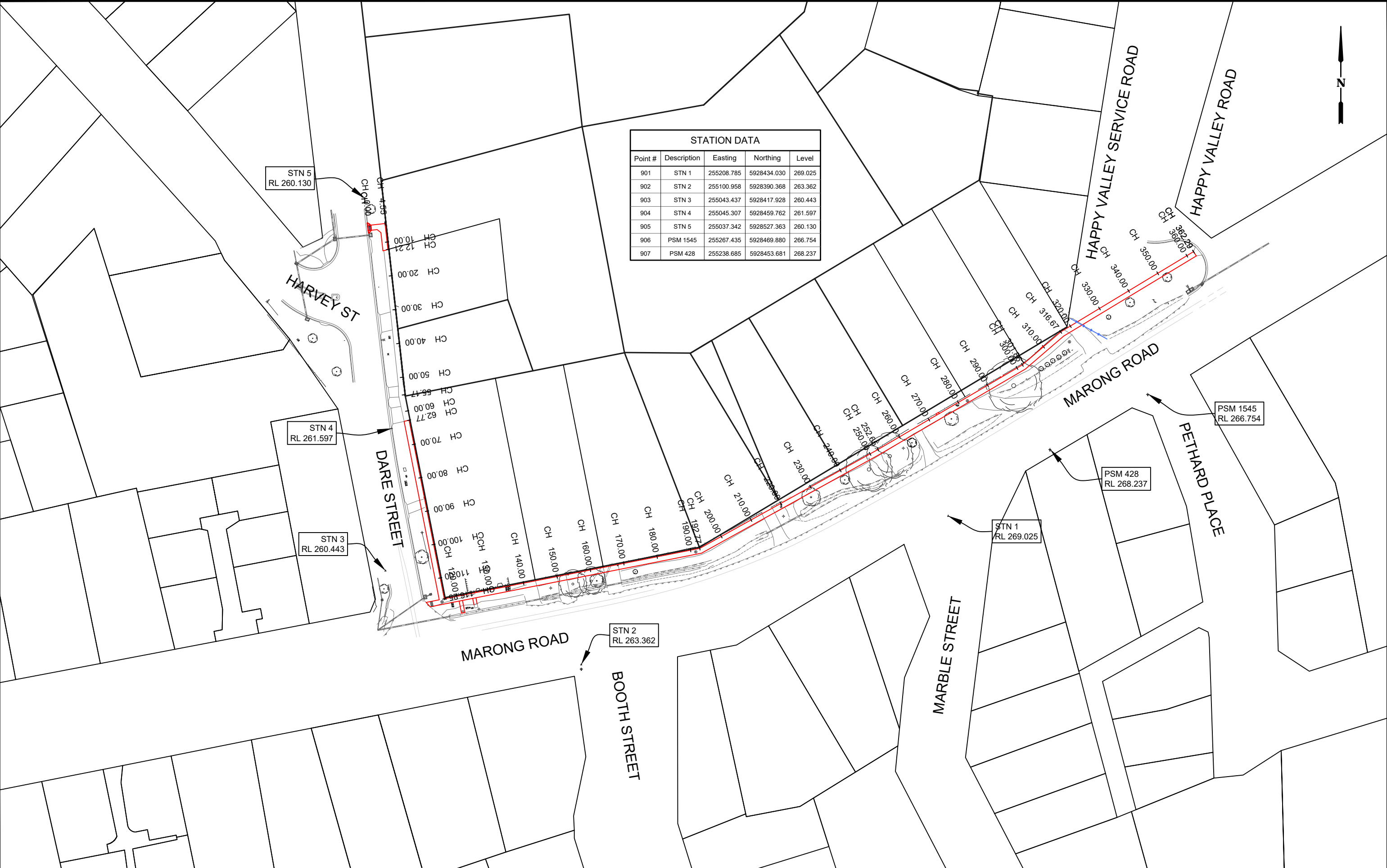

STATION DATA				
Point #	Description	Easting	Northing	Level
901	STN 1	255208.785	5928434.030	269.025
902	STN 2	255100.958	5928390.368	263.362
903	STN 3	255043.437	5928417.928	260.443
904	STN 4	255045.307	5928459.762	261.597
905	STN 5	255037.342	5928527.363	260.130
906	PSM 1545	255267.435	5928469.880	266.754
907	PSM 428	255238.685	5928453.681	268.237



CITY OF GREATER
BENDIGO

PROJECT DESIGN STATUS		
Surveyor:	H. Whytock	30/03/2023
Designer:	A. Smith	04/04/2023
Draft Checked:	L. Oliver	xx/xx/23
Tender Approved:	N. SARTORI	xx/xx/23

PRELIMINARY DESIGN
DRAFT 3

PROJECT DETAILS	
Location:	Marong Road
Suburb:	West Bendigo
Works:	Footpath
GB No:	GB5098

SHEET DETAILS	
OVERALL LATOUT & CONTROL	
Sheet number:	3 of 10
Plan Scale:	1 : 1000
Plotted: 24/05/2023 By: Andrew Smith	
SHEET REVISIONS AFTER TENDER	
Revision	Description
-	-
-	-
-	-

Approved by	Date
-	-
-	-
-	-

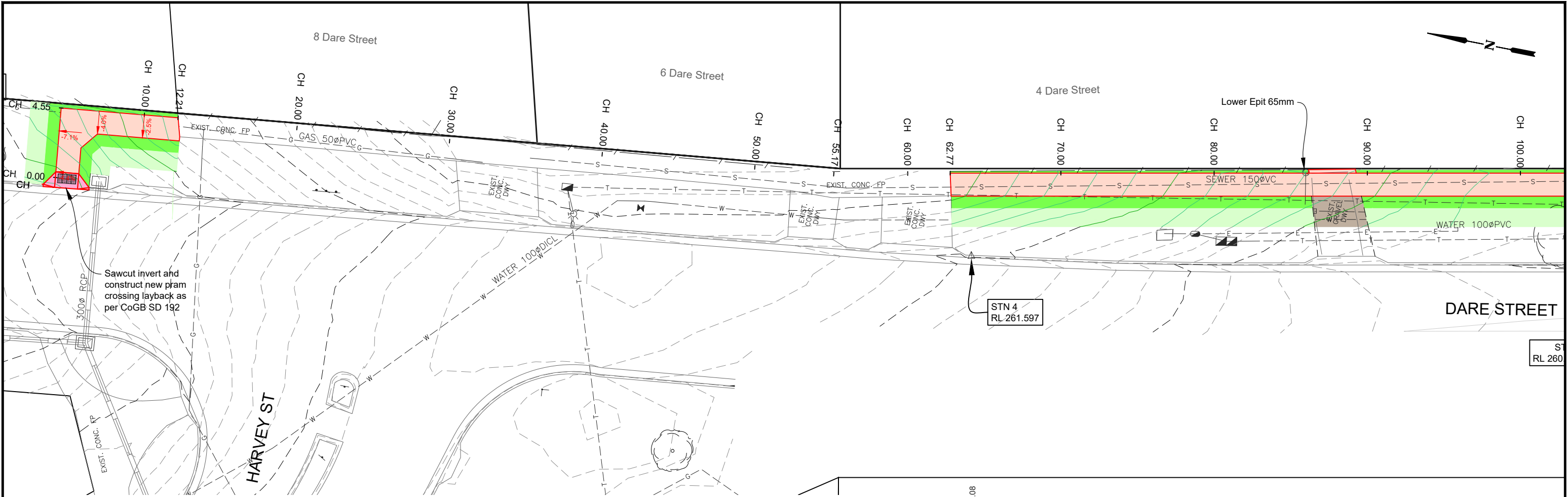

FP LONGITUDINAL SECTION CH 4.554 To 100.000
SCALES: H 1:250 V 1:100 (A3)

DESIGN CONTOURS
- Levels to AHD (0.10m interval)

EXISTING CONTOURS
- Levels to AHD (0.10m interval)

Concrete Kerb area: Normal plain
Kerb per IDM SD100 &
CoGB SD190,191,192

Concrete Footpath area: Normal plain
Footpath as per IDM SD 205 & SD210

Concrete Driveway area: Normal plain
Dwy as per IDM SD240

Asphalt Driveway area:
as per IDM SD206

Gravel Driveway area:
50mm depth of Class 3 FCR

Existing tree to be removed

Landscape work: Proposed Tree
Plant as directed by CoGB Parks

Landscaping: Instant turf
(Refer: Typical details pg 2)

Landscaping: topsoil and seed
(Refer: Typical details pg 2)

PROJECT DESIGN STATUS

Surveyor:	H. Whytock	30/03/2023
Designer:	A. Smith	04/04/2023
Draft Checked:	L. Oliver	xx/xx/23
Tender Approved:	N. SARTORI	xx/xx/23

**PRELIMINARY DESIGN
DRAFT 3**

PROJECT DETAILS

Location:	Marong Road
Suburb:	West Bendigo
Works:	Footpath
GB No:	GB5098

SHEET DETAILS

LAYOUT PLAN & LONG SECTION		Sheet number: 4 of 10
		Plan Scale: 1:250 A3
		Plotted: 24/05/2023 By: Andrew Smith
SHEET REVISIONS AFTER TENDER		
Revision	Description	Approved By Date
-	-	- -
-	-	- -
-	-	- -

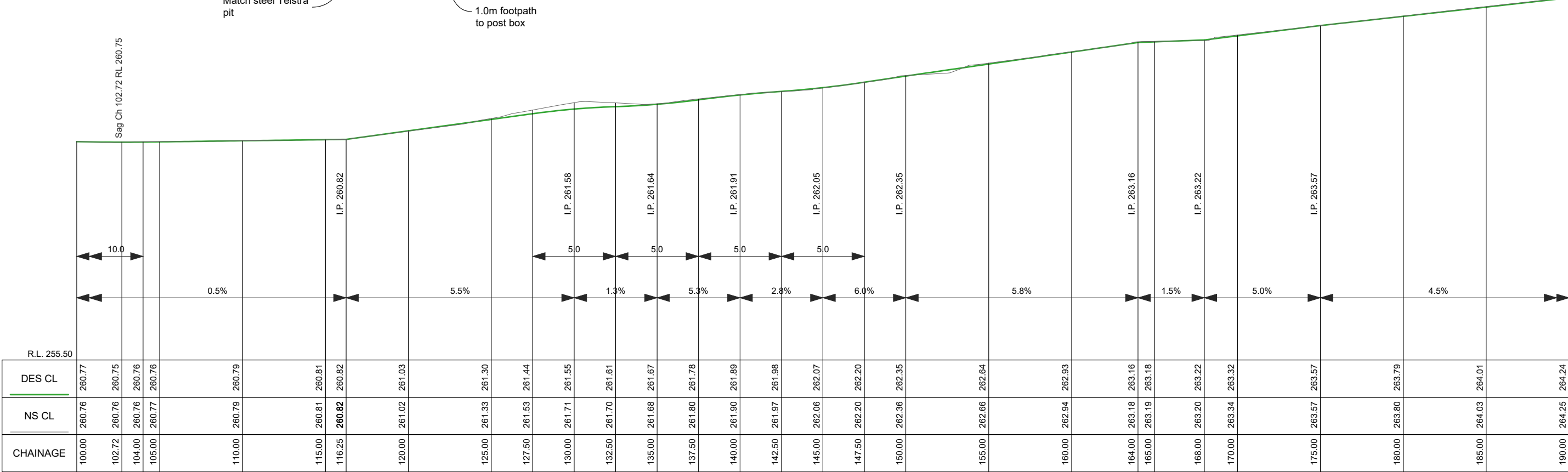
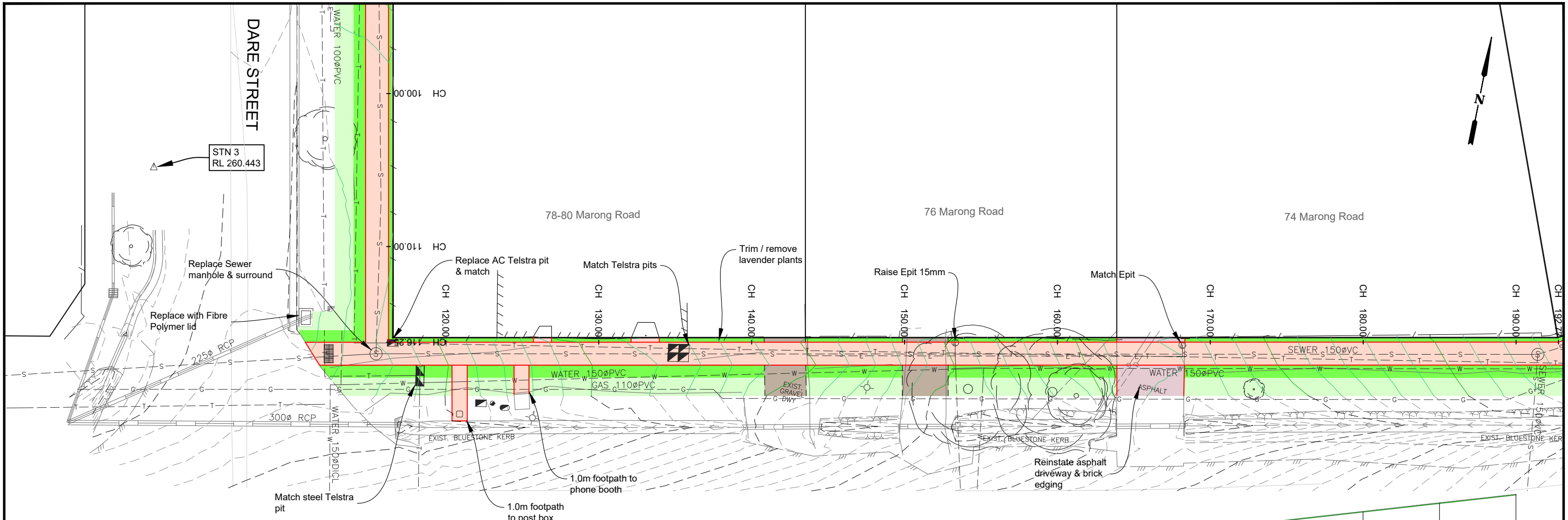

FP LONGITUDINAL SECTION CH 100.000 To 190.000
SCALES: H 1:250 V 1:100 (A3)

DESIGN CONTOURS
- Levels to AHD (0.10m interval)

EXISTING CONTOURS
- Levels to AHD (0.10m interval)

Concrete Kerb area: Normal plain
Kerb per IDM SD100 &
CoGB SD190,191,192

Concrete Footpath area: Normal plain
Footpath as per IDM SD 205 & SD210

Concrete Driveway area: Normal plain
Dwy as per IDM SD240

Asphalt Driveway area:
as per IDM SD206

Gravel Driveway area:
50mm depth of Class 3 FCR

Existing tree to be removed

Landscape work: Proposed Tree
Plant as directed by CoGB Parks

Landscaping: Instant turf
(Refer: Typical details pg 2)

Landscaping: topsoil and seed
(Refer: Typical details pg 2)

PROJECT DESIGN STATUS		
Surveyor:	H. Whytock	30/03/2023
Designer:	A. Smith	04/04/2023
Draft Checked:	L. Oliver	xx/xx/23
Tender Approved:	N. SARTORI	xx/xx/23

PRELIMINARY DESIGN
DRAFT 3

PROJECT DETAILS	
Location:	Marong Road
Suburb:	West Bendigo
Works:	Footpath
GB No:	GB5098

SHEET DETAILS			
LAYOUT PLAN & LONG SECTION	Sheet number: 5 of 10		
	Plan Scale: 1:250 A3		
Plotted: 24/05/2023 By: Andrew Smith			
SHEET REVISIONS AFTER TENDER			
Revision	Description	Approved by	Date
-	-	-	-
-	-	-	-
-	-	-	-

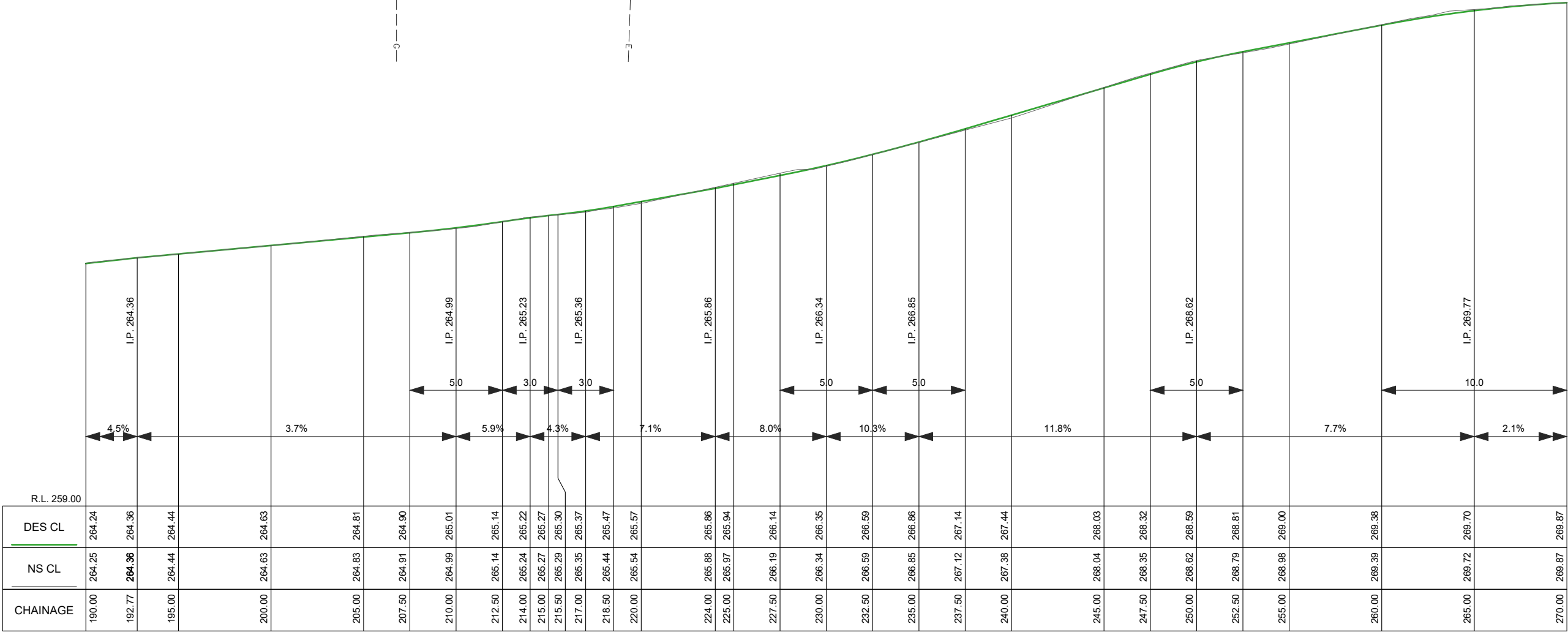
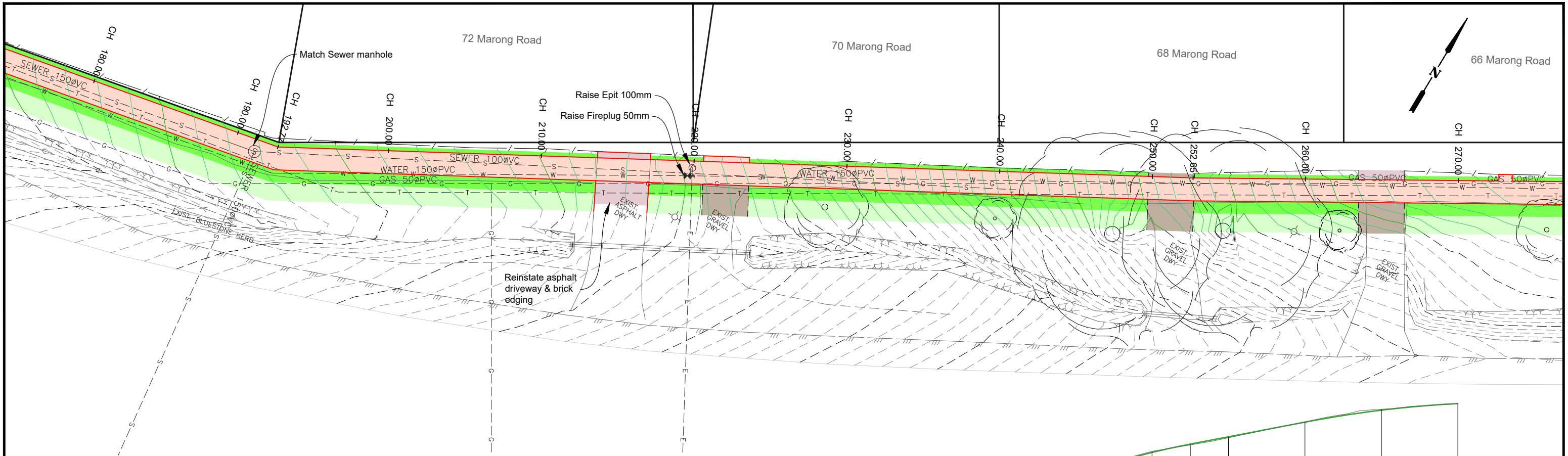

FP LONGITUDINAL SECTION CH 190.000 To 270.000
SCALES: H 1:250 V 1:100 (A3)

DESIGN CONTOURS
- Levels to AHD (0.10m interval)

EXISTING CONTOURS
- Levels to AHD (0.10m interval)

Concrete Kerb area: Normal plain
Kerb per IDM SD100 &
CoGB SD190,191,192

Concrete Footpath area: Normal plain
Footpath as per IDM SD 205 & SD210

Concrete Driveway area: Normal plain
Dwy as per IDM SD240

Asphalt Driveway area:
as per IDM SD206

Gravel Driveway area:
50mm depth of Class 3 FCR

Existing tree to be removed

Landscape work: Proposed Tree
Plant as directed by CoGB Parks

Landscaping: Instant turf
(Refer: Typical details pg 2)

Landscaping: topsoil and seed
(Refer: Typical details pg 2)

PROJECT DESIGN STATUS

Surveyor:

H. Whytock

30/03/2023

Designer:

A. Smith

04/04/2023

Draft Checked:

L. Oliver

xx/xx/23

Tender Approved:

N. SARTORI

xx/xx/23

PRELIMINARY DESIGN
DRAFT 3

PROJECT DETAILS

Location:

Marong Road

Suburb:

West Bendigo

Works:

Footpath

GB No:

GB5098

SHEET DETAILS

LAYOUT PLAN &
LONG SECTION

Sheet number:

6 of 10

Plan Scale:

1:250

Plotted:

24/05/2023

By: Andrew Smith

SHEET REVISIONS AFTER TENDER

Revision	Description	Approved by	Date
-	-	-	-
-	-	-	-
-	-	-	-

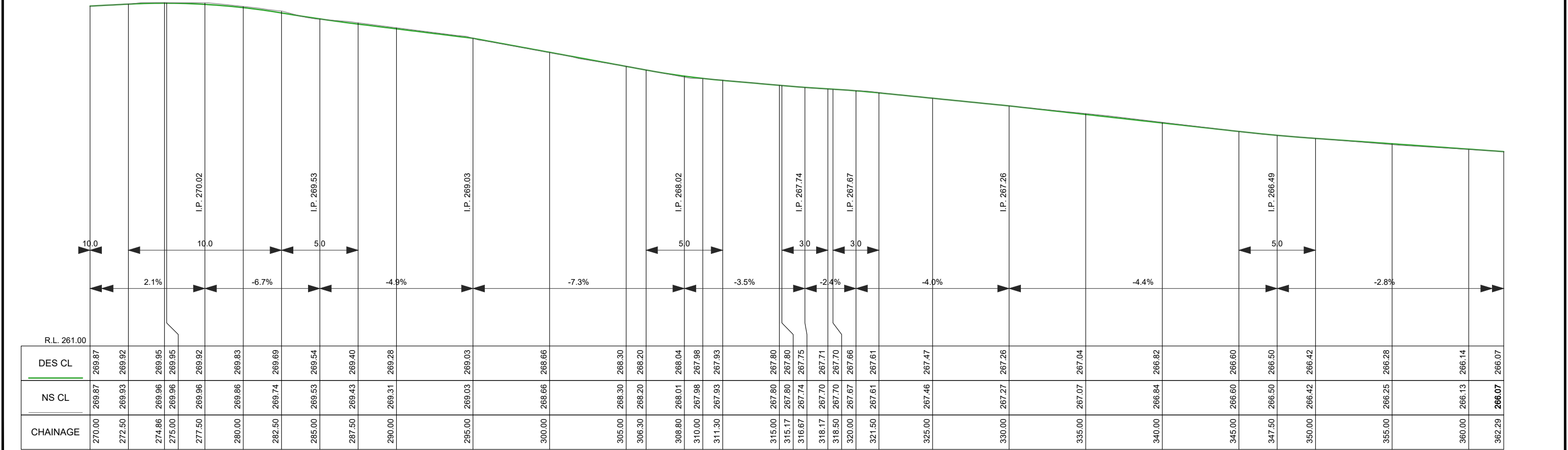
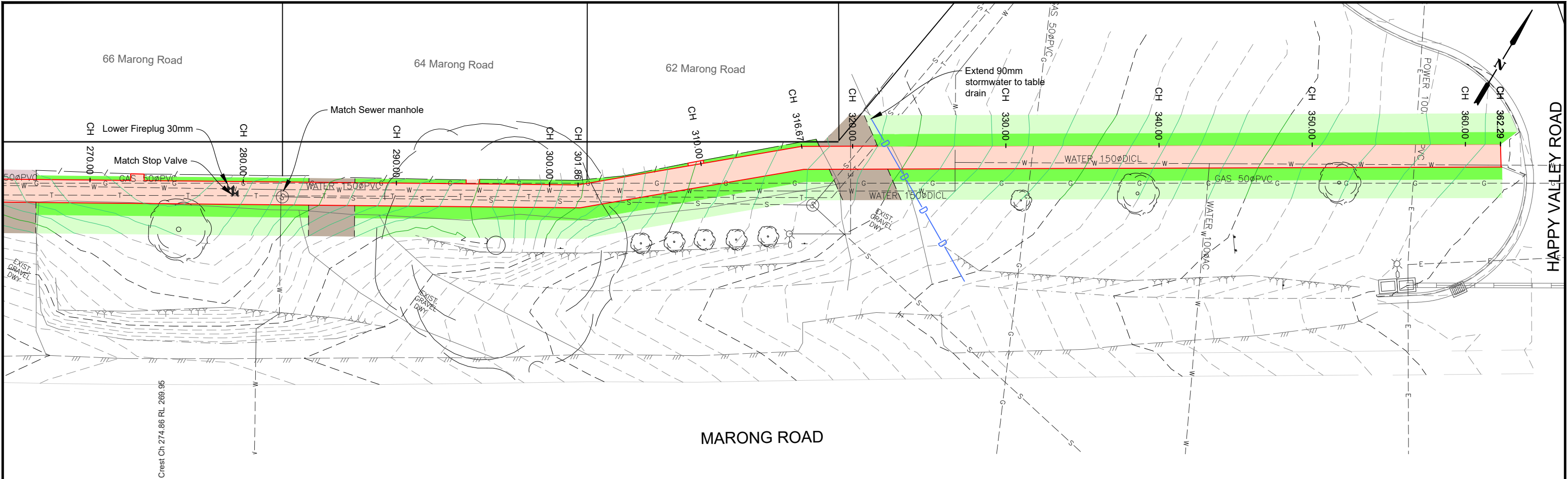

FP LONGITUDINAL SECTION CH 270.000 To 362.291
SCALES: H 1:250 V 1:100 (A3)

LEGEND

DESIGN CONTOURS
- Levels to AHD (0.10m interval)

EXISTING CONTOURS
- Levels to AHD (0.10m interval)

Concrete Kerb area: Normal plain
Kerb per IDM SD100 &
CoGB SD190,191,192

Concrete Footpath area: Normal plain
Footpath as per IDM SD 205 & SD210

Concrete Driveway area: Normal plain
Dwy as per IDM SD240

Asphalt Driveway area:
as per IDM SD206

Gravel Driveway area:
50mm depth of Class 3 FCR

Existing tree to be removed

Landscape work: Proposed Tree
Plant as directed by CoGB Parks

Landscaping: Instant turf
(Refer: Typical details pg 2)

Landscaping: topsoil and seed
(Refer: Typical details pg 2)

CITY OF GREATER
BENDIGO

PROJECT DESIGN STATUS

Surveyor:	H. Whytock	30/03/2023
Designer:	A. Smith	04/04/2023
Draft Checked:	L. Oliver	xx/xx/23
Tender Approved:	N. SARTORI	xx/xx/23

**PRELIMINARY DESIGN
DRAFT 3**

PROJECT DETAILS

Location: Marong Road
Suburb: West Bendigo
Works: Footpath
GB No: GB5098

SHEET DETAILS

LAYOUT PLAN & LONG SECTION

Sheet number: 7 of 10
Plan Scale: 1:250
Plotted: 24/05/2023 By: Andrew Smith

Revision	Description	Approved by	Date
-	-	-	-
-	-	-	-
-	-	-	-

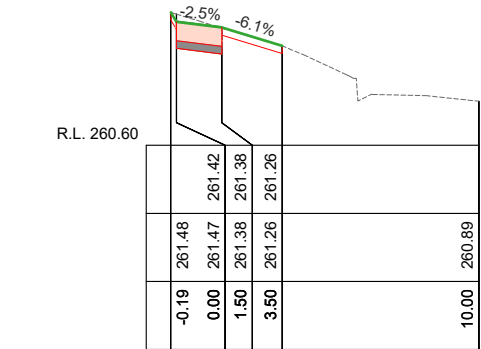

Ch 80.00

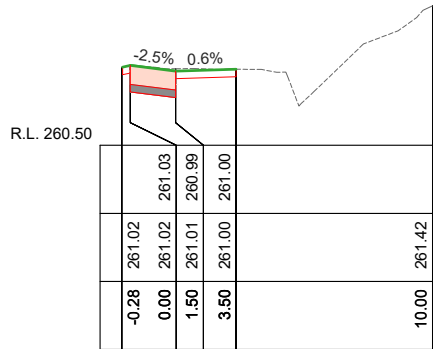

Ch 120.00

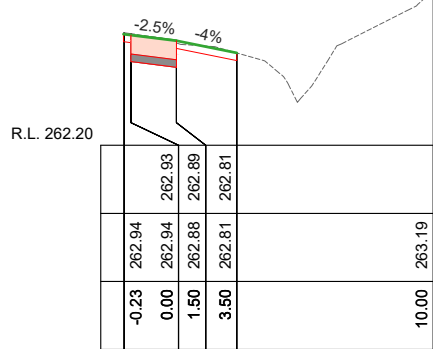

Ch 160.00

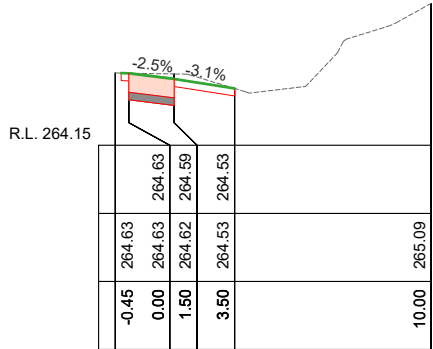

Ch 200.00

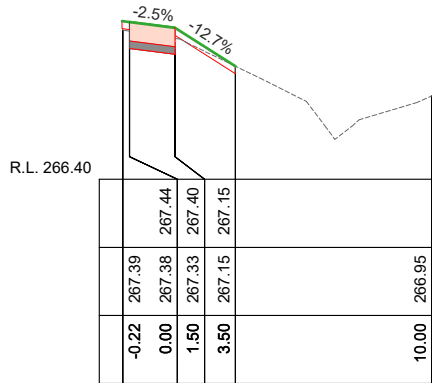

Ch 240.00

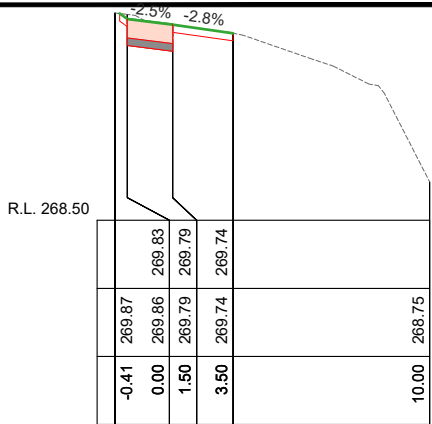

Ch 280.00

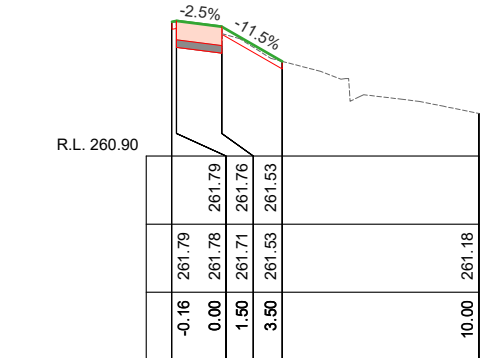

Ch 70.00

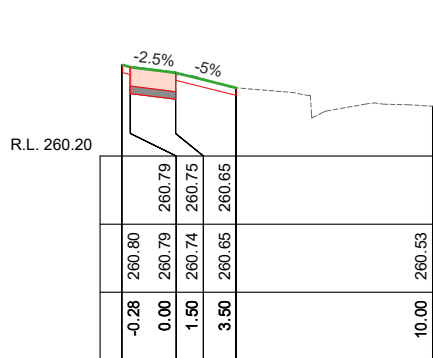

Ch 110.00

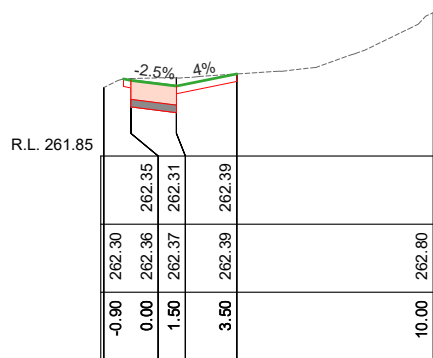

Ch 150.00

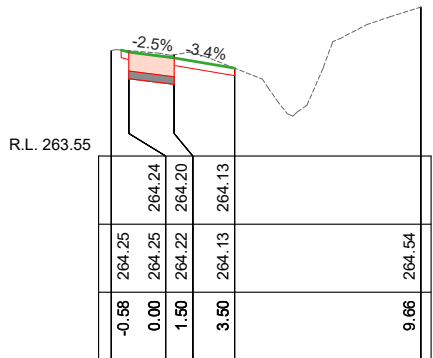

Ch 190.00

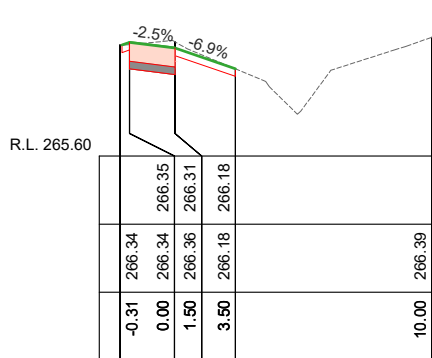

Ch 230.00

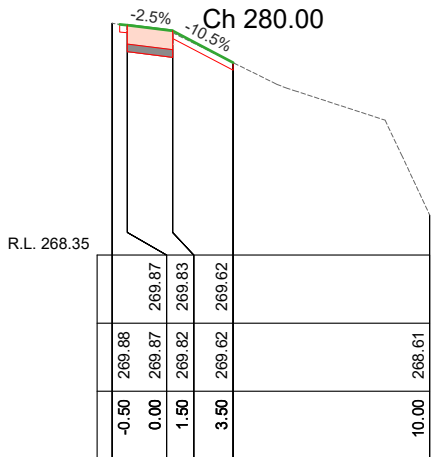

Ch 270.00

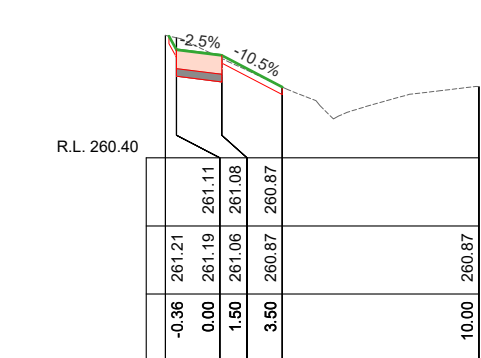

Ch 10.00

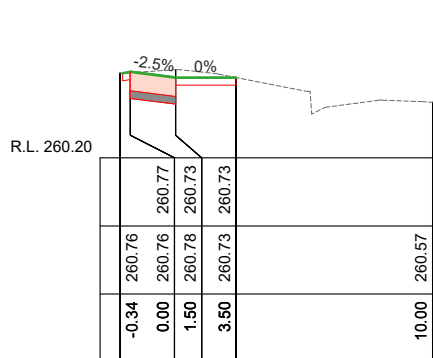

Ch 100.00

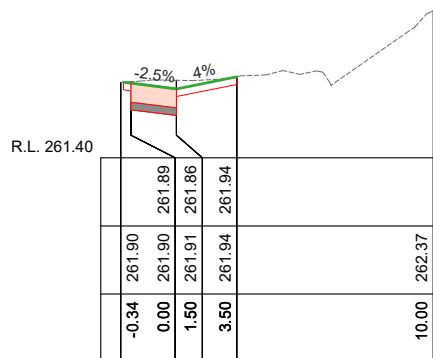

Ch 140.00

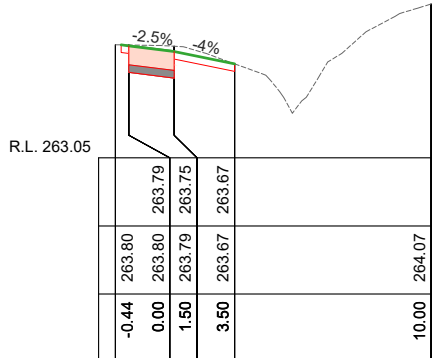

Ch 180.00

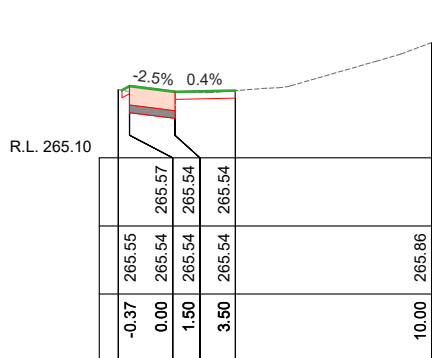

Ch 220.00

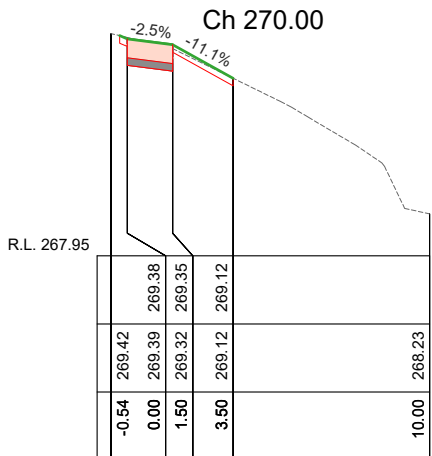

Ch 260.00

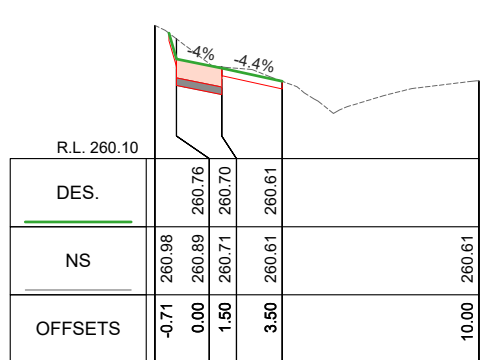

Ch 5.00

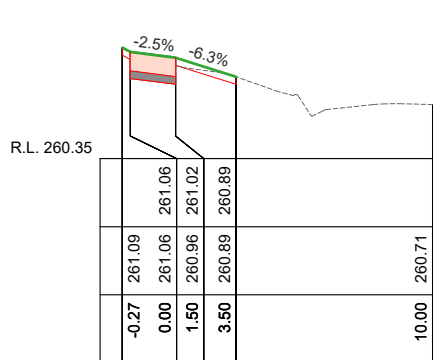

Ch 90.00

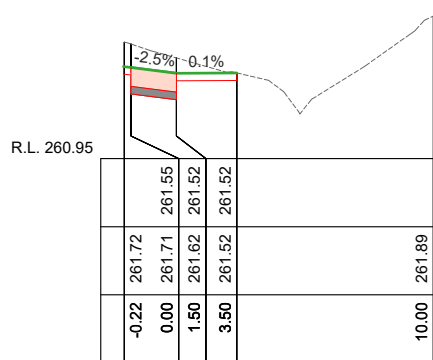

Ch 130.00

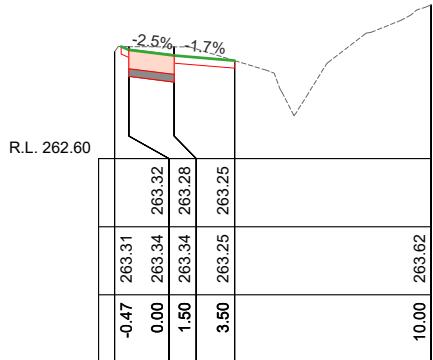

Ch 170.00

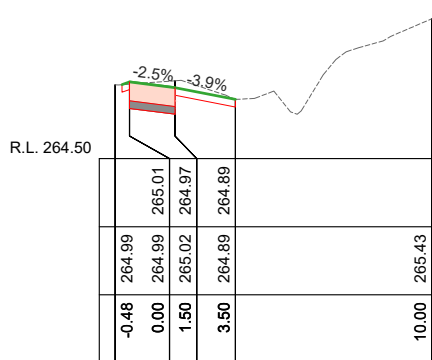

Ch 210.00

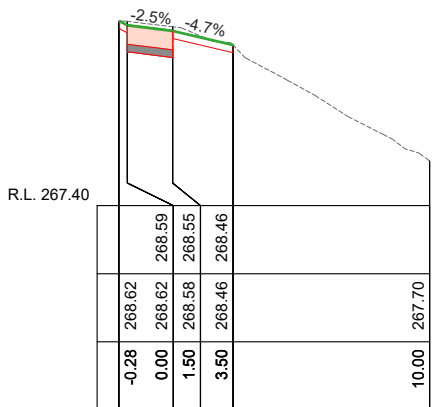

Ch 250.00

FP CROSS SECTIONS
SCALES: H 1:250 V 1:50 (A3)

DES.	260.98	260.76	260.70	260.61		260.61
NS	260.98	260.89	260.71	260.61		260.61
OFFSETS	-0.71	0.00	1.50	3.50		10.00



PROJECT DESIGN STATUS		
Surveyor:	H. Whytock	30/03/2023
Designer:	A. Smith	04/04/2023
Draft Checked:	L. Oliver	xx/xx/23
Tender Approved:	N. SARTORI	xx/xx/23
PRELIMINARY DESIGN DRAFT 3		

PROJECT DETAILS	
Location:	Marong Road
Suburb:	West Bendigo
Works:	Footpath
GB No:	GB5098

SHEET DETAILS		
CROSS SECTIONS		Sheet number: 8 of 10
		Plan Scale: AS SHOWN A3
		Plotted: 24/05/2023 By: Andrew Smith
SHEET REVISIONS AFTER TENDER		
Revision	Description	Approved by Date
-	-	-
-	-	-
-	-	-

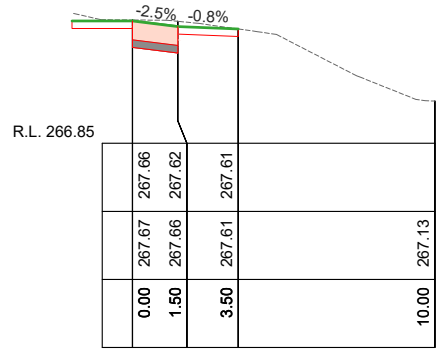

Ch 320.00

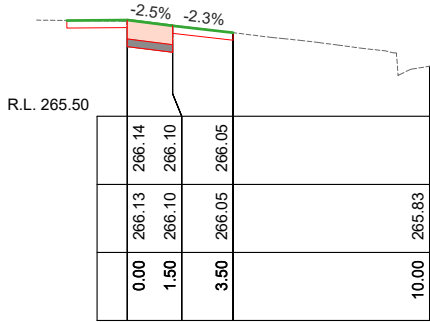

Ch 360.00

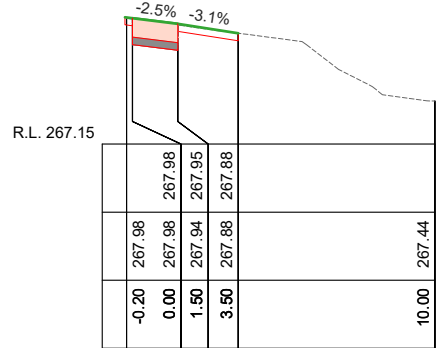

Ch 310.00

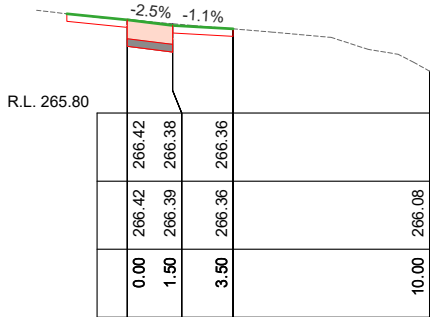

Ch 350.00

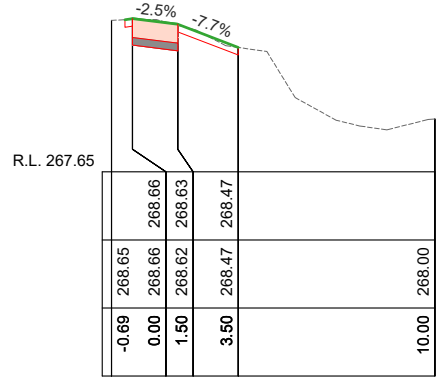

Ch 300.00

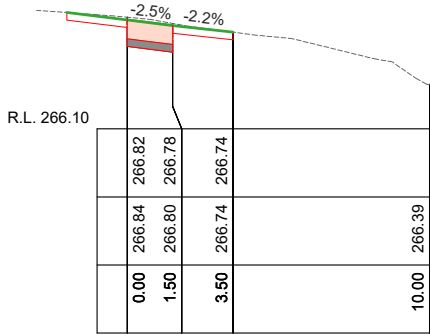

Ch 340.00

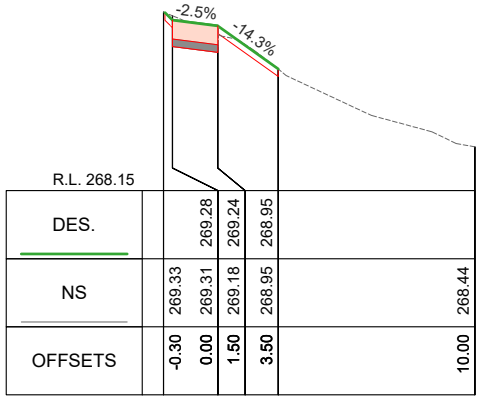

Ch 290.00

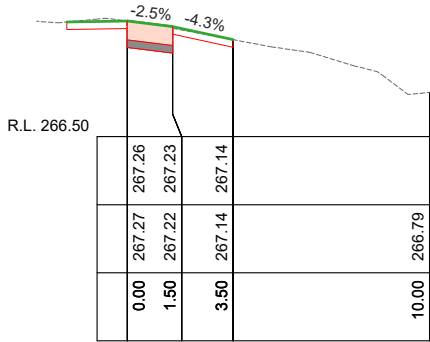

Ch 330.00

FP CROSS SECTIONS
SCALES: H 1:250 V 1:50 (A3)



PROJECT DESIGN STATUS		
Surveyor:	H. Whytock	30/03/2023
Designer:	A. Smith	04/04/2023
Draft Checked:	L. Oliver	xx/xx/23
Tender Approved:	N. SARTORI	xx/xx/23

PRELIMINARY DESIGN
DRAFT 3

PROJECT DETAILS	
Location:	Marong Road
Suburb:	West Bendigo
Works:	Footpath
GB No:	GB5098

SHEET DETAILS			
CROSS SECTIONS		Sheet number: 9 of 10	
		Plan Scale: AS SHOWN	A3
		Plotted: 24/05/2023 By: Andrew Smith	
SHEET REVISIONS AFTER TENDER			
Revision	Description	Approved by	Date
-	-	-	-
-	-	-	-
-	-	-	-

STATION DATA				
Point #	Description	Easting	Northing	Level
901	STN 1	255208.785	5928434.030	269.025
902	STN 2	255100.958	5928390.368	263.362
903	STN 3	255043.437	5928417.928	260.443
904	STN 4	255045.307	5928459.762	261.597
905	STN 5	255037.342	5928527.363	260.130
906	PSM 1545	255267.435	5928469.880	266.754
907	PSM 428	255238.685	5928453.681	268.237

PRELIMINARY DESIGN
DRAFT 3